

Professional Power Tools & Accessories  
May – August 2024

# PRO NEWS



## New Products

Including Nailer Range  
and VDE Hand Tools

## PRO DEALS

Free batteries, dust  
solutions, levelling  
accessories and more

## Services

Including Bosch On  
Site, After Sales  
Service, PRO360



# BOSCH

# WHERE TO FIND US?

## Social Media

Follow our social media pages to keep up with the latest product releases, online campaigns, tool demonstrations, product reviews and so much more.

Don't hesitate to get in contact with us here if you need any help or support.

@BoschProfessionalPowerToolsUK



@BoschProUK



@BoschProfessionalUK



## NEWSLETTER

Register now for the Bosch Professional Newsletter and be the first to receive exclusive offers & promotions as well as:

- ▶ Personalised content on our latest products and services
- ▶ First pick in some of our exciting competitions
- ▶ Find out about tool testing opportunities
- ▶ ...and so much more.

Register now at

[www.bosch-professional.com/gb/en/newsletter](http://www.bosch-professional.com/gb/en/newsletter)



## WEBSITE

Visit our website at [www.bosch-professional.co.uk](http://www.bosch-professional.co.uk) for our full range of products & accessories, spec sheets and product manual downloads.



Visit our Pro360 App for easy tool management & extend your tool & battery warranty to up to **3 years**

For more information please visit [www.bosch-professional.co.uk](http://www.bosch-professional.co.uk)

INNOVATIONS: <b>NEW</b> ProCORE18V+	4 - 5
INNOVATIONS: <b>NEW</b> ProCORE18V+	6 - 7
INNOVATIONS: <b>NEW</b> GDS 18V-1600 HC Professional Impact Wrench	8
INNOVATIONS: <b>NEW</b> GDS 18V-320 C Professional Impact Wrench	9
INNOVATIONS: <b>NEW</b> GCB 18V-127 Professional Band Saw	10
INNOVATIONS: <b>NEW</b> GHO 18V-26 Professional Planer	11
INNOVATIONS: <b>NEW</b> GNH 18V-64-2 M Professional Nail Gun	12
INNOVATIONS: <b>NEW</b> GNH 18V-64 MD Professional Nail Gun	13
INNOVATIONS: <b>NEW</b> GNH 18V-50 M Professional Nail Gun	14
INNOVATIONS: <b>NEW</b> GTH 18V-38 M Professional Nail Gun	15
INNOVATIONS: <b>NEW</b> GDR 18V-220 C Professional Impact Driver	16
INNOVATIONS: <b>NEW</b> BITURBO GRA 18V2-46 Professional Lawn Mower	17
INNOVATIONS: <b>NEW</b> GWS 12-125 Professional Angle Grinder	18
INNOVATIONS: <b>NEW</b> GHT 130 Professional Floor Removal Cart	19
INNOVATIONS: <b>NEW</b> Professional Water Pump / Wrench 250mm Ironman Plier	20 - 21
INNOVATIONS: <b>NEW</b> Professional VDE Hand Tool Range	22 - 22
INNOVATIONS: GTC Professional Thermal Camera Range	24 - 25
CAMPAIGN: Measuring Tools: Robustness	26 - 27
CAMPAIGN: Dust Control	28 - 31
PRODEALS: <b>NEW</b> Rewards	32 - 33
MARKETING ACTIVITY: Bosch On Site	34 - 35
PRICE LIST	36 - 45
SERVICE & SUPPORT: Bosch After Sales Service	46
SERVICE & SUPPORT: MaxPrice Repair Offer	47
SERVICE & SUPPORT: PRO360 - 3 Years Guarantee	48 - 49
SERVICE & SUPPORT: AMPShare	50

We reserve the right to amend technical specifications, drawings and recommended prices are non-binding. No liability can be accepted for printing errors. The prices and promotions contained herein are not applicable to the Republic of Ireland; this information is provided for the review of product specifications only.

# REDEFINING THE HIGH-PERFORMANCE BATTERY

## The new ProCORE18V+ 8.0Ah

The next generation of high-power batteries is here. With tabless cell technology, ProCORE18V+ gives your BITURBO tools more performance and longer runtime vs. ProCORE18V batteries, so you can perform heavy-duty applications with ease.

### REVOLUTIONARY TABLESS CELL TECHNOLOGY

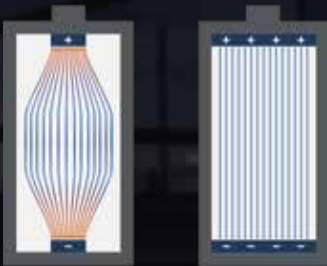

TAB DESIGN

TABLESS DESIGN

#### The advantage of tabless cells:

Countless parallel current paths instead of single tabs ensure less inner resistance and therefore less heat.



**DISCOVER ProCORE18V+**  
[Bosch-professional.com](https://www.bosch-professional.com)

### GET MORE FOR YOUR HEAVY-DUTY AP



**+71%** longer runtime for drilling in concrete<sup>1</sup>

<sup>1</sup>ProCORE18V+ 8.0Ah vs. ProCORE18V 8.0Ah. Tested with GBH 18V-45 C: dia. 25 mm drilling in concrete C30/37; drill bit 8X dia. 25 x 400 mm; 150 mm holes; 30s drilling, 30s break. <sup>2</sup>ProCORE18V+ 8.0Ah vs. ProCORE18V 8.0Ah. Tested with GWX 18V-15 SC, Grinding with a Bosch flap disk (2608619209) at 30-second intervals with a 5-second break in between. Application on a 200 x 10 steel plate (mild steel). <sup>3</sup>ProCORE18V+ 8.0Ah vs. ProCORE18V 8.0Ah. Tested with GCM 18V-305 GDC, Cutting a Spruce wood: 100 x 100 mm (no breaks). Cutting disc: Expert for Wood, 305 x 2,2/1,6 x 30 mm, 60 Teeth (2 608 644 528)

## GET MORE FROM A SINGLE CHARGE

ProCORE18V+ has a runtime up to 71% longer<sup>1</sup>, helping you to increase your efficiency on heavy-duty applications.

## PROLONGED BATTERY LIFE

Exceptional heat management from COOLPACK 2.0 and tabless cell technology gives your ProCORE18V+ battery a longer lifetime<sup>2</sup>.

## ONE BATTERY FITS ALL

ProCORE18V+ is compatible with new and existing Bosch Professional tools in the same voltage class since 2008 and the multi-brand battery alliance, AMPShare.



## APPLICATIONS WITH PROCORE18V+



**+44%** longer runtime for grinding steel plate<sup>2</sup>



**+41%** longer runtime for cutting wood<sup>3</sup>

DESCRIPTION	PART NUMBER	BOSCH LIST PRICE (EX. VAT)	BOSCH LIST PRICE (INC. VAT)
ProCORE18V+ 8.0Ah (carton) Battery	1600A02X00	£183.04	£219.65

# REDEFINING THE HIGH-PERFORMANCE BATTERY

## The new ProCORE18V+ 8.0Ah

Revolutionary tabless cell technology ensures a longer runtime and maximum power for your heavy-duty applications.

up to **1,000W<sup>1</sup>**

### ProCORE18V **4.0<sup>Ah</sup>**

All the power of a conventional battery – but without the weight. Best for strenuous positions (e.g. overhead work)



### ProCORE18V **5.5<sup>Ah</sup>** **8.0<sup>Ah</sup>**

The perfect balance of weight and power. Best paired with BITURBO tools for maximum performance



**NEW**

**UP TO 71%<sup>4</sup> LONGER RUNTIME**

For heavy-duty applications thanks to the highly innovative tabless cell technology

**EXTENDED BATTERY LIFETIME<sup>3</sup>**

Thanks to outstanding heat management with COOLPACK 2.0 and the tabless cell technology

up to **2,000W<sup>2</sup>**

### ProCORE18V+ **8.0<sup>Ah</sup>**

Revolutionary tabless cell technology provides longer runtime for BITURBO tools – ensuring maximum power for your heavy-duty applications



### ProCORE18V **12.0<sup>Ah</sup>**

Maximum performance and longest runtime. Best paired with BITURBO tools for maximum performance to complete extreme applications



# DISCOVER THE ADVANTAGES OF PROCORE18V+ 8.0AH



## ProCORE18V

### PERFORMANCE

- Up to 2,000W equivalent corded power with ProCORE18V  $\geq 5.5\text{Ah}$ , optimally suited for BITURBO tools
- Up to 1,000W equivalent corded power with ProCORE18V 4.0Ah, but more compact and lightweight than a standard battery

### CELLS

- 21700 high-performance cells

### HEAT MANAGEMENT

- COOLPACK 2.0 technology more than doubles the lifetime of standard batteries without COOLPACK 2.0
- No air gaps between the cells: every cell is fully covered with HDPE material for optimal heat dissipation
- Cooper cell connectors for lower resistance, less power loss, and highly efficient heat release

## PROCORE18V+ 8.0 Ah

**NEW**

- Up to 2,000W equivalent corded power with ProCORE18V+ 8.0Ah, optimally suited for BITURBO tools
- **Up to 71%<sup>4</sup> longer runtime for heavy-duty applications** thanks to the highly innovative tabless cell technology
- **ProCORE18V+ 8.0Ah most compact battery with highest energy density** (compared to competition's high performance batteries in same capacity and voltage class)

- **Tabless** 21700 high-performance cells with countless parallel current paths
- **50% lower inner resistance<sup>5</sup>**
- **Less battery heating**
- **Longer runtime**

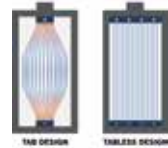

- Same benefits as ProCORE18V
- **Extended battery lifetime<sup>3</sup>** thanks to outstanding heat management with COOLPACK 2.0 and the tabless cell technology

## ONE BATTERY FITS ALL

ProCORE18V+ is compatible with new and existing Bosch Professional tools in the same voltage class since 2008 and the multi-brand battery alliance, AMPShare.

Our 3-years guarantee covers even batteries and chargers. Completely free of charge with a few clicks in PRO360 within 4 weeks after the purchase. The offer applies to all professional power and measuring tools.



<sup>1</sup> Battery with cordless tool provides up to 1,000W of equivalent corded power.

<sup>2</sup> Battery with cordless tool provides up to 2,000W of equivalent corded power.

<sup>3</sup> Internal test results of lifetime comparison of ProCORE18V+ 8.0Ah vs. ProCORE18V 4.0Ah.

<sup>4</sup> ProCORE18V+ 8.0Ah vs. ProCORE18V 8.0Ah. Tested with GBH 18V-45 C: dia. 25 mm drilling in concrete C30/37; drill bit 8X dia. 25x400 mm; 150 mm holes; 30s drilling, 30s break.

<sup>5</sup> 50% lower inner resistance on cell level, 28% lower resistance on battery pack level

<sup>6</sup> After registration in PRO360.com

<sup>6</sup> After registration in PRO360.com

**NEW**

## GDS 18V-1600 HC PROFESSIONAL IMPACT WRENCH

**Exceptional cordless power:  
¾" high-torque impact wrench with  
BITURBO Brushless technology**

**Ideal for:** Industrial metal fabrication, metal installation, locksmiths, automotive, civil engineering

**Application:** Manufacturing and repair of metal-based products, maintenance and installation of industrial plants



### BITURBO Brushless

High performance brushless motor maximises the full potential of ProCORE18V batteries

### Heavy Duty Performance

Extreme power for tough applications: up to 1,600Nm tightening torque and 2,200Nm breakaway torque, engineered for toughest applications in heavy industry

### Adjustable Screw Modes

Two default modes: A and B, further modes are available via Bosch Toolbox App. Each mode can be customised and adapted to the users' specific applications

### Controlled Power

Three speed settings provide excellent control over speed/torque for high versatility, displayed via tool status indicator

TECHNICAL DATA	GDS 18V-1600 HC PROFESSIONAL IMPACT WRENCH
Max. tightening torque	1,600 Nm
Max. breakaway torque	2,200 Nm
No-load speed	0 – 800 / 1,300 / 1,750 rpm
Anvil type	¾"
Impact rate	0 – 1,550 / 2,200 / 2,350 bpm
Screw diameter (min. – max.)	M16 – M33
Weight (excl. battery)	3.2 kg
Tool dimensions (LxWxH)	226 x 86 x 242 mm



**BITURBO**  
BRUSHLESS

DESCRIPTION	PART NUMBER	BOSCH LIST PRICE (EX. VAT)	BOSCH LIST PRICE (INC. VAT)	
GDS 18V-1600 HC (body only, carton)	BITURBO Brushless 18V I/Wrench	06019M1000	£306.06	£367.28
GDS 18V-1600 HC (body only, L-BOXX)	BITURBO Brushless 18V I/Wrench	06019M1001	£341.07	£409.28
GDS 18V-1600 HC (2x ProCORE18V 8.0Ah, GCY42, 1x GAL 1880 CV, L-BOXX)	BITURBO Brushless 18V I/Wrench	06019M1070	£634.92	£761.90





**NEW**

**GDS 18V-320 C  
PROFESSIONAL  
IMPACT WRENCH**

**Compact and lightweight 3/8" impact wrench with adjustable modes for multi-purpose use**

**Ideal for:** Metal installation, locksmith, machine repair/fabrication, plumbing, HVAC, electricians, automotive

**Application:** Fixing and maintenance of metal-based products, installation and repair of plumber/HVAC applications

**Compact and Light Weight**

145mm length to work in tight spaces, only 1.2 kg in weight (excl. battery)

**Fast Working Progress**

3,800bpm, up to 320Nm tightening torque and 540Nm breakaway torque

**Controlled Power**

Three speed settings provide excellent control over output speed/torque, tool condition status indicator

**Adjustable Modes**

2 default modes (metal and wood), further modes including custom mode available via the Bosch Toolbox App, each mode can be customised and adapted to the user's specific application

**Belt Clip**

Option to place the tool on belt



TECHNICAL DATA	GDS 18V-320 C PROFESSIONAL IMPACT WRENCH
Max. tightening torque	320 Nm
Max. breakaway torque	540 Nm
No-load speed	0 – 1,200 / 1,900 / 2,900 rpm
Anvil type	3/8"
Impact rate	0 – 2,400 / 3,100 / 3,800 bpm
Screw diameter (min. – max.)	M6 – M16
Weight (excl. battery)	1.2 kg
Tool dimensions (LxWxH)	145 x 77 x 205 mm

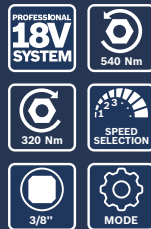

**DESCRIPTION**

GDS 18V-320 C (body only, carton) 18V I/Wrench

**PART NUMBER**

06019L5100

**BOSCH LIST PRICE (EX. VAT)**

£208.16

**BOSCH LIST PRICE (INC. VAT)**

£249.80

**NEW**

## GCB 18V-127 PROFESSIONAL BAND SAW

**Powerful brushless band saw for high-depth fast and nearly spark-free cuts in metal**

**Ideal for:** Plumbers, HVAC, electricians, metal installation, locksmiths

**Application:** Cutting of pipes and profiles out of diverse metals and PVC



### Health and User Protection

Low-vibration and almost spark-free cuts in metal, lock-off button to avoid unintended switch on, restart protection, and metal protective cover

### High Productivity

Powerful brushless motor for high performance

### High Convenience when Cutting

Variable-speed trigger switch and speed-dial, enabling great control  
Material guide and smooth saw blade action for more accurate and cleaner cuts  
Constant electronic for virtually consistent speed, overload protection and hanging hook



### High Cutting Capacity

Cutting capacity of 127 x 127 mm

### Simplicity

Tool-free exchange of band saw blade

TECHNICAL DATA	GCB 18V-127 PROFESSIONAL BAND SAW
Cutting capacity	127 x 127 mm
Blade speed	30 – 115 m/min
Saw blade dimensions	1,140 x 12.4 x 0.5 mm
LED light	Yes
Weight (excl. battery)	6.45 kg
Tool dimensions (LxWxH)	530 x 210 x 280 mm



### DESCRIPTION

	PART NUMBER	BOSCH LIST PRICE (EX. VAT)	BOSCH LIST PRICE (INC. VAT)
GCB 18V-127 (body only, carton) 18V B/Saw	06012B7000	£471.50	£565.80



**NEW**

**GHO 18V-26 PROFESSIONAL PLANER**

**Perfectly flat surfaces thanks to high precision design**

**Ideal for:** Cabinet installer, framing, door installer

**Application:** Cabinet planing, frame adjustments, rebating



**Carbide reversible planer knife**

**Corded Equivalent Performance**

Thanks to a powerful brushless motor and a constant speed electronic

**Increased Planing Depth**

2.6mm planing depth allowing to fulfil different application needs



**3 Times More Cuts vs Predecessor**

Thanks to the new Wood-Razor Tungsten Carbide tipped blade. Less down time, more cost-efficient

**Improved and Flexible Dust Management**

More dust and chips ejected than before and dual chip ejection (left or right)

**3 V-Grooves**

For easy chamfering in various depths

**Perfectly Flat Planed Wood**

Guaranteed thanks to the exact alignment between base plate and depth adjustment plate

TECHNICAL DATA	GHO 18V-26 PROFESSIONAL PLANER
Planing depth	2.6 mm
Planing width	82 mm
No-load speed	13,600 rpm
Weight (excl. battery)	2.46 kg
Tool dimensions (LxWxH)	289 x 151 x 185 mm

**DESCRIPTION**

GHO 18V-26 (body only, carton, 1x extra blade, 1x parallel guide, 1x dust bag) Brushless 18V Planer

GHO 18V-26 (body only, L-BOXX, 1x extra blade, 1x parallel guide, 1x dust bag) Brushless 18V Planer

Carbide reversible planer knife 82mm



PART NUMBER	BOSCH LIST PRICE (EX. VAT)	BOSCH LIST PRICE (INC. VAT)
06015B5001	£227.39	£272.87
06015B5000	£260.83	£313.00
2607000096	£12.25	£14.70

**NEW**

## GNH 18V-64-2 M PROFESSIONAL NAIL GUN

**Cordless freedom with the power of a pneumatic tool: gasless 16 GA (1.6mm) finish nailer with bump fire mode**

**Ideal for:** Cabinet installer, fLOORER (wood), window & door installer

**Application:** Window & door castings, stair balusters, wainscots, crown mouldings, skirting boards

### Wide View Contact Tip

Wide viewing area for better visibility to the work piece and precise positioning of nails

### Toolless Jam Clearing

Quick and easy access to remove jammed nails

### Dry Fire Lock-Out

Wood Protection System avoids damage to work piece by preventing blank firing when nail magazine is empty



### Easy-To-Use Stepless Depth Adjustment

Ergonomic thumbwheel for precise and quick depth setting, viewing window for quick check of current depth setting

### Thumb-Actuated Power Switch

Easy single-handed activation and deactivation avoiding unnecessary work interruptions

### User Interface

Easy switch between single and contact firing mode, service alert for scheduled tool maintenance avoiding unnecessary interruption of the workday



TECHNICAL DATA	GNH 18V-64-2 M PROFESSIONAL NAIL GUN
Nail size (wire diameter)	16 ga / 1.6 mm
Nail length	32 – 64 mm
Magazine angle	20°
Activation modes	Single / Contact
Weight (excl. battery)	3 kg
Tool dimensions (LxWxH)	283 x 96 x 336 mm



### DESCRIPTION

	PART NUMBER	BOSCH LIST PRICE (EX. VAT)	BOSCH LIST PRICE (INC. VAT)
GNH 18V-64-2 M (body only, carton) 18V N/Gun	0601482000	£526.66	£631.99
GNH 18V-64-2 M (body only, L-BOXX) 18V N/Gun	0601482001	£554.33	£665.20



**NEW**

**GNH 18V-64 MD  
PROFESSIONAL  
NAIL GUN**

**Gasless and cordless 15 GA  
(1.8mm) nail gun with pneumatic  
performance and bump fire mode**

**Ideal for:** Cabinet installer, floorer (wood),  
window & door installer

**Application:** Window & door castings, stair  
clusters, wainscots, crown mouldings,  
skirting boards

**Wide View  
Contact Tip**

Wide viewing area  
for better visibility to  
the work piece and  
precise positioning  
of nails

**Easy-To-Use Stepless  
Depth Adjustment**

Ergonomic thumbwheel for  
precise and quick depth  
setting, viewing window  
for quick check of current  
depth setting

**Toolless Jam  
Clearing**

Quick and easy access  
to remove jammed nails

**Thumb-Actuated  
Power Switch**

Easy single-handed  
activation and  
deactivation avoiding  
unnecessary work  
interruptions

**Dry Fire Lock-Out**

Wood Protection System  
avoids damage to work piece  
by preventing blank firing  
when nail magazine is empty

**User Interface**

Easy switch between  
single and contact  
firing mode, service  
alert for scheduled tool  
maintenance avoiding  
unnecessary interruption of  
the workday



TECHNICAL DATA	GNH 18V-64 MD PROFESSIONAL NAIL GUN
Nail size (wire diameter)	15 ga / 1.8 mm
Nail length	32 – 64 mm
Magazine angle	34°
Activation modes	Single / Contact
Weight (excl. battery)	3.1 kg
Tool dimensions (LxWxH)	323 x 95 x 385 mm



**DESCRIPTION**

	PART NUMBER	BOSCH LIST PRICE (EX. VAT)	BOSCH LIST PRICE (INC. VAT)
GNH 18V-64 MD (body only, carton) 18V N/Gun	0601482200	£533.98	£640.78
GNH 18V-64 MD (body only, L-BOXX) 18V N/Gun	0601482201	£560.85	£673.02

**NEW**

## GNH 18V-50 M PROFESSIONAL NAIL GUN

**Gasless and cordless 18 GA  
(1.2mm) nail gun with pneumatic  
performance and bump fire mode**

**Ideal for:** Cabinet installer, foorer (wood),  
window & door installer, glazier

**Application:** Skirting boards, furniture  
building/cabinet assembly, decorative  
mouldings/trims, window & door casing,  
glazing beads



### Easy-To-Use Stepless Depth Adjustment

Ergonomic thumbwheel  
for precise and quick  
depth setting, viewing  
window for quick check  
of current depth setting

### Narrow Nose

For better  
visibility to the  
work piece  
and precise  
positioning of  
nails

### Toolless Jam Clearing

Quick and easy  
access to remove  
jammed nails

### Dry Fire Lock- Out

Wood Protection  
System avoids damage  
to work piece by  
preventing blank firing  
when nail magazine  
is empty



### Thumb-Actuated Power Switch

Easy single-handed activation  
and deactivation avoiding  
unnecessary work interruptions

### User Interface

Easy switch between single  
and contact firing mode,  
service alert for scheduled  
tool maintenance avoiding  
unnecessary interruption of the  
workday

TECHNICAL DATA	GNH 18V-50 M PROFESSIONAL NAIL GUN
Nail size (wire diameter)	18 ga / 1.2 mm
Nail length	16 – 50 mm
Magazine angle	0°
Activation modes	Single / Contact
Weight (excl. battery)	3 kg
Tool dimensions (LxWxH)	276 x 96 x 337 mm



### DESCRIPTION

DESCRIPTION	PART NUMBER	BOSCH LIST PRICE (EX. VAT)	BOSCH LIST PRICE (INC. VAT)
GNH 18V-50 M (body only, carton) 18V N/Gun	0601482400	£530.86	£637.03
GNH 18V-50 M (body only, L-BOXX) 18V N/Gun	0601482401	£559.28	£671.14

**NEW****GTH 18V-38 M  
PROFESSIONAL  
NAIL GUN**

**Cordless and gasless narrow crown stapler with pneumatic performance and bump fire mode**

**Ideal for:** Cabinet installer, floorer (wood), façade insulation

**Application:** Upholstery, ceiling & floor panels, furniture panels, wire fence, trellis, acoustic construction

**Narrow Nose**

For better visibility to the work piece and precise positioning of nails

**Flywheel Drive**

Less fatigue due to very low recoil

**Dry Fire Lock-Out**

Wood Protection System avoids damage to work piece by preventing blank firing when nail magazine is empty

**Easy-To-Use Stepless Depth Adjustment**

Ergonomic thumbwheel for precise and quick depth setting, viewing window for quick check of current depth setting

**Thumb-Actuated Power Switch**

Easy single-handed activation and deactivation avoiding unnecessary work interruptions

**User Interface**

Easy switch between single and contact firing mode, service alert for scheduled tool maintenance avoiding unnecessary interruption of the workday

TECHNICAL DATA	GTH 18V-38 M PROFESSIONAL NAIL GUN
Nail size (wire diameter)	18 ga / 1.2 mm
Nail length	10 – 38 / 5.8 mm
Magazine angle	0°
Activation modes	Single / Contact
Weight (excl. battery)	3.1 kg
Tool dimensions (LxWxH)	276 x 95 x 329 mm

**DESCRIPTION**

DESCRIPTION	PART NUMBER	BOSCH LIST PRICE (EX. VAT)	BOSCH LIST PRICE (INC. VAT)
GTH 18V-38 M (body only, carton) 18V N/Gun	0601482500	£540.89	£649.07
GTH 18V-38 M (body only, L-BOXX) 18V N/Gun	0601482501	£569.32	£683.18

**NEW**

## GDR 18V-220 C PROFESSIONAL IMPACT DRIVER

The most compact Bosch  
Professional 18V impact driver

**Ideal for:** Plumber, HVAC, joiner, cabinet installation, electrician, drywaller

**Application:** Installation, maintenance, repair of sanitation systems, fixing of wooden & sheet metal façade elements



### Perfect Handling

1/4" hex anvil with one-handed bit insertion for a quick and easy insertion of bits without pulling the sleeve



35 Piece impact control screwdriver bit set

### LED Worklight

Two LEDs - one in the head and one in the foot of the tool provide best in class workplace illumination

### Tool Control and User Protection

3 Speed settings for better control over the tool depending on the application, two default screw modes (A: Auto Slow-down + B: Auto Shut-off) help to prevent damage before it occurs, further modes and adjustments available via mobile App

### Strong Performance and Convenient Driving

Brushless motor delivers 3400 max rpm and a high torque of 220Nm for a fast work progress

### Ergonomic Design

Slim design with a compact head length of only 113mm



TECHNICAL DATA	GDR 18V-220 C PROFESSIONAL IMPACT DRIVER
Anvil size	1/4"
Max. tightening torque	220 Nm
No-load speed	0 – 800 / 2,300 / 3,400 rpm
Impact Rate	0 – 1,500 / 3,400 / 4,000 bpm
Screw diameter (min. – max.)	M6 – M16
Weight (excl. battery)	1 kg
Tool dimensions (LxWxH)	117 x 77 x 201 mm



DESCRIPTION	PART NUMBER	BOSCH LIST PRICE (EX. VAT)	BOSCH LIST PRICE (INC. VAT)
GDR 18V-220 C (body only, carton) Brushless 18V I/Driver	06019L6000	£193.12	£231.74
GDR 18V-220 C (body only, L-BOXX) Brushless 18V I/Driver	06019L6001	£228.23	£273.87
Multiconstruction drill and impact control screwdriver bit set, 35 pcs	2608577147	£57.79	£69.35





**NEW**

**GRA 18V2-46 PROFESSIONAL LAWN MOWER**

**High performance lawn mower with convenient handling and robust design**

**Ideal for:** Facility managers, existing Professional 18V battery system users

**Application:** Grass and outdoor applications

**Strong Performance**

2x 18V batteries for increased performance and runtime with powerful BITURBO brushless motor and 46cm cutting diameter

**Robust Metal Deck for Extended Lifetime**

Full metal deck, no plastic inserts, robust metal handle frame with bail bar

**Improved Ergonomics and Protection**

Ergonomic soft grip handle with 2-level height adjustment and low noise at 94dB(A)

**Convenient Cutting, Collection, Mulching and Storage**

6-level cutting height adjustment (30mm to 70mm), 60L fabric grass basket, mulching plug and space saving storage including vertical option thanks to collapsible handle



TECHNICAL DATA	GRA 18V2-46 PROFESSIONAL LAWN MOWER
No-load speed	3,100 rpm
Grass bag capacity	60 L
Cutting width	46 cm
Height of cut	30 – 70 mm
Cutting height levels	6
Weight (excl. battery)	25 kg
Motor type	BITURBO Brushless
Mulching feature	Yes



**BITURBO**  
BRUSHLESS

**DESCRIPTION**

DESCRIPTION	PART NUMBER	BOSCH LIST PRICE (EX. VAT)	BOSCH LIST PRICE (INC. VAT)
GRA 18V2-46 (body only, carton) 18V2 BITURBO Brushless L/Mower	06008C8000	£412.29	£494.75
AC (GRA): Mower blade (46cm), carton	F016800638	£24.50	£29.40

**NEW**

## GWS 12-125 PROFESSIONAL ANGLE GRINDER

**Compact, convenient yet powerful – 1,200W small angle grinde**

**Ideal for:** Industrial metal fabrication, general construction

**Application:** Cutting & grinding



### Compact and Convenient Design

Compact and lightweight design for convenient working and tool control, smallest grip size in this power class, keyless guard system

### Higher Performance

With +100W / +200W more power and working efficiency compared to predecessor models



### Improved Motor Cooling

Air inlets at the backside of the tool provides better airflow for motor cooling and prevents dust from accumulating in the motor

### Health

Restart protection, clip-on cutting guard for cutting applications included in scope of supply

TECHNICAL DATA	GWS 12-125 PROFESSIONAL ANGLE GRINDER
Voltage	110 / 240 V
Corded input power	1,050 / 1,200 W
Blade size	125 mm
Spindle	M14
No-load speed	11,000 rpm
Cutting depth	32 mm
Weight	2.4 kg
Tool dimensions (LxWxH)	293 x 228 x 108 mm



**FITS ALL**

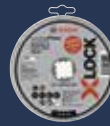
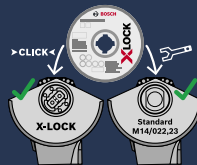

**X-LOCK Standard for Inox Tin**



**Expert X-LOCK Carbide Multi Wheel Cutting Disc**



**Expert X-LOCK Diamond Metal Wheel Cutting Disc**

### DESCRIPTION

	PART NUMBER	BOSCH LIST PRICE (EX. VAT)	BOSCH LIST PRICE (INC. VAT)
GWS 12-125 (110V) A/Grinder (body only, carton)	06013A6160	£104.72	£125.66
GWS 12-125 (220-240V) A/Grinder (body only, carton)	06013A6170	£104.72	£125.66
X-LOCK Standard for Inox Tin 125 mm	2608619267	£15.82	£18.98
Expert X-LOCK Diamond Metal Wheel Cutting Disc 125 mm	2608900533	£34.67	£41.60
Expert X-LOCK Carbide Multi Wheel Cutting Disc 125 mm	2608901193	£22.42	£26.90

Promotions and pricing available from 01/05/2024 to 31/08/2024 or while stocks last. Bosch List Price is for illustrative purposes and dealers shall determine their own resale price.



**NEW**

**GHT 130 PROFESSIONAL FLOOR REMOVAL CART**

Remove floor covers fast and easily when used with a GSH 16 – perfect support for a physically demanding task

**Ideal for:** General contractor, demolition contractor, floorer wood contractor, tiler

**Application:** Removal of floor covers, floor tiles, vinyl, cork, wooden surfaces

**Fast Removal**

Quick removal of floor covers via ease of use

**Quick Set-Up of Trolley**

Fast mounting and demounting of breaker hammer due to star knobs

**Easier Floor Cover Removal**

Less strain on the operators back and less operator fatigue as the weight of the hammer is carried by the trolley and not by the operator

**Remove Floor Covers Ergonomically**

5 adjustable working positions

TECHNICAL DATA	GHT 130 PROFESSIONAL FLOOR REMOVAL CART
Angle working adjustment	5 positions
Compatibility	GSH 16-28
Related accessories	Scraper, Wide chisel, Flat chisel
Weight	27.5 kg
Trolley dimensions (LxWxH)	1000 x 400 x 300 mm

**DESCRIPTION**

GHT 130 (carton) Floor Removal Cart  
 GSH 16-28 (110V) Breaker (carry case)  
 GSH 16-28 (240V) Breaker (carry case)

PART NUMBER	BOSCH LIST PRICE (EX. VAT)	BOSCH LIST PRICE (INC. VAT)
1600A02JY7	£1,249.82	£1,499.78
0611335060	£1,555.98	£1,867.18
0611335070	£1,555.98	£1,867.18

**NEW**

## PROFESSIONAL WATER PUMP / WRENCH 250MM IRONMAN PLIERS

Ergonomic design with robust chrome vanadium steel

**Ideal for:** HVAC, plumber, installation

**Application:** Nuts, pipes, fixings



### Flexible

Adjustable to the workpiece in 2mm steps, fine adjustment (20 positions), 46mm max. capacity

### Professional Water Pump 250mm Ironman Pliers



### Long Lifetime

Robust chrome vanadium steel for long lifetime, extra hardened teeth, stable plug-in joint

### Comfortable Usage

Ergonomic handle with comfort soft grip, plier head self-clamping to the workpiece, adjustable directly on the workpiece, clamping protection to avoid injuries



### Long Lifetime

Robust chrome vanadium steel for long lifetime, stable plug-in joint

### Flexible

Adjustable to the workpiece in 2mm steps, fine adjustment (21 positions), suitable for sensitive surfaces, 48 mm max. capacity for nuts

### Professional Wrench 250mm Ironman Pliers

TECHNICAL DATA	WATER PUMP 250MM IRONMAN PLIERS	WRENCH 250MM IRONMAN PLIERS
Max. capacity	46 mm / 1.8"	48 mm / 1.9"
Fine adjustment	20 positions	21 positions
Weight	359 g	546 g
Dimensions (LxWxH)	252 x 53 x 20 mm	266 x 56 x 25 mm



DESCRIPTION	PART NUMBER	BOSCH LIST PRICE (EX. VAT)	BOSCH LIST PRICE (INC. VAT)
Water Pump 250mm Ironman Pliers	1600A02W3N	£29.26	£35.11
Wrench 250 mm Ironman Plier	1600A02W3R	£49.32	£59.19

Promotions and pricing available from 01/05/2024 to 31/08/2024 or while stocks last. Bosch List Price is for illustrative purposes and dealers shall determine their own resale price.



**NEW**

**PROFESSIONAL S-SHAPE CORNER 45° / CORNER 90° PIPE WRENCH 420MM**

Ergonomic design with robust chrome vanadium steel

**Ideal for:** HVAC, plumber, installation  
**Application:** Nuts, pipes, fixings

**Comfortable Usage**

Ergonomic design, s-shape enables a stable three-point position directly on the pipe, 45° jaw position, adjustable directly on the workpiece, clamping protection to avoid injuries



**Professional S-Shape Corner Pipe Wrench 45° 420mm**

**Flexible**

Adjustment nut for stepless fine adjustment, 60mm / 2 3/8" max. capacity for pipes

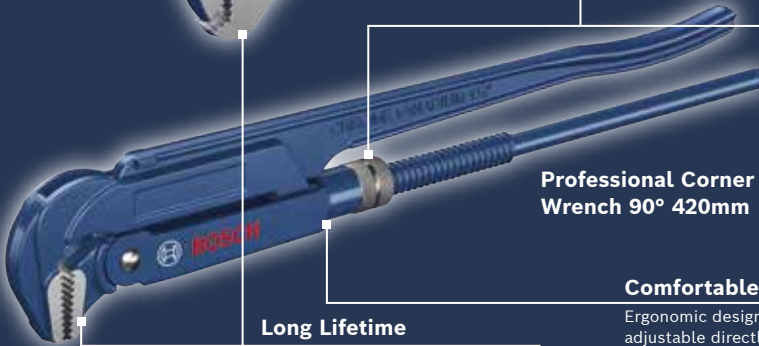

**Professional Corner Pipe Wrench 90° 420mm**

**Comfortable Usage**

Ergonomic design, 90° jaw position, adjustable directly on the workpiece, clamping protection to avoid injuries

**Long Lifetime**

Robust chrome vanadium steel for long lifetime, extra hardened teeth, stable plug-in joint

TECHNICAL DATA	S-SHAPE CORNER PIPE WRENCH 45° 420MM	CORNER PIPE WRENCH 90° 420MM
Max. capacity	60 mm / 2 3/8"	60 mm / 2 3/8"
Jaw position	45°	90°
Weight	1.38 kg	1.31 kg
Dimensions (LxWxH)	420 x 84 x 26 mm	425 x 70 x 26 mm



PART NUMBER	BOSCH LIST PRICE (EX. VAT)	BOSCH LIST PRICE (INC. VAT)
1600A02W3T	£45.98	£55.18
1600A02W3V	£45.98	£55.18

**DESCRIPTION**

S-Shape Corner Pipe Wrench 45° 420mm  
Corner Pipe Wrench 90° 420mm

**NEW**

## PROFESSIONAL VDE HAND TOOL RANGE

Proven Bosch Professional quality – VDE certified

**Ideal for:** Electrician, HVAC, plumber

**Application:** Cutting & stripping wires, removing insulation, cable management brackets, fuse box



PRODUCT	SIZES
Screwdriver PH	1, 2
Screwdriver SL	2.5, 3.5, 4.5, 5.5, 6.5
Screwdriver TX	10, 15, 20, 25, 30, 40
Screwdriver PZ	1, 2, 3
Screwdriver SL / PH	1, 2
Screwdriver SL / PZ	1, 2
Single Pole Phase Tester SL	3
Spanner	8, 10, 13, 17 mm
Cable knife	One size
Dismantling Knife	One size
Diagonal Side Cutter	160 mm
Combination Plier	180 mm
High Leverage Diagonal Side Cutter	200 mm
Long Nose Plier Straight	200 mm
Long Nose Plier Bent (40°)	200 mm
Water Pump Plier	250 mm
Crimping Plier	180 mm
Universal Wire Stripper	160 mm
Cable Shear	200 mm

DESCRIPTION	PART NUMBER	BOSCH LIST PRICE (EX. VAT)	BOSCH LIST PRICE (INC. VAT)
VDE Spanner set 4pc	1600A02NE8	£54.34	£65.21
VDE Socket Wrench set 6pc	1600A02NF3	£82.76	£99.32
VDE Screwdriver set SL/PH 7pc	1600A02NF7	£34.28	£41.13
VDE Screwdriver set TX 7pc	1600A02NF8	£33.44	£40.13
VDE Screwdriver set 14pc	1600A02NF9	£75.24	£90.29
VDE Plier set 3pc	1600A02NG0	£54.34	£65.21
VDE Plier set 4pc	1600A02NG1	£71.90	£86.28
VDE Mixed set 5pc	1600A02NG2	£54.34	£65.21
VDE Mixed set 7pc	1600A02NG3	£72.73	£87.28

Individual executions are also available – Please see price list or contact your retailer.

**NEW**

**BOSCH PROFESSIONAL VDE HAND TOOLS**

# INSULATED, SIMPLE AND CONVENIENT

## The new Bosch Professional VDE hand tools range: A must for Electricians and HVACs

Tested up to 10,000 volts and VDE-certified up to 1,000 volts according to DIN EN/IEC 60900.

The independent and neutral “VDE Prüf- und Zertifizierungsinstitut GmbH” is a nationally and internationally accredited institution for the testing and certification of electric equipment, components, and systems.



1.000 V



DIN EN/IEC  
60900



## GTC PROFESSIONAL THERMAL CAMERA RANGE

Including Bosch Thermal App connectivity

**Ideal for:** Tradespeople, electricians, HVAC, installations

**Application:** Insulation detection, hot & cold spot detection





**GTC 600 C**

Detailed visualisation of temperatures with smart documentation and voice note feature

**GTC 400 C**

Protected thermal camera with picture in picture technology

**Bosch Thermal App**

Record daily measurements though fast image transfer and documentation

**Professional 12V System**

The flexible battery system can be powered by a 12V Li-Ion battery or with standard alkaline batteries

TECHNICAL DATA	GTC 600 C	GTC 400 C
Measurement range*	-20 °C to +600 °C	-10 °C to +400 °C
Measuring accuracy of IR*	± 2.0 °C* (*plus use-dependent deviation)	± 3.0 °C* (*plus use-dependent deviation)
Resolution	0.1° C	0.1° C
Thermal sensitivity (NETD)	<50 mK	<50 mK
Size of IR sensor	256 x 192 px	160 x 120 px
Number of measuring points	49,152	19,200
Frame buffer (number of images)	600	500
File format of image	.jpg	.jpg
Data transfer	Wi-Fi, USB-C®	MicroUSB, Wi-Fi
Size of display	3.5"	3.5"



DESCRIPTION	PART NUMBER	BOSCH LIST PRICE (EX. VAT)	BOSCH LIST PRICE (INC. VAT)
GTC 400 C (L-BOXX)	0601083171	£1,071.67	£1,286.01
GTC 400 C (body only, L-BOXX)	0601083108	£1,004.66	£1,217.65
GTC 600 C (L-BOXX)	0601083570	£1,583.12	£1,899.74
GTC 600 C (body only, L-BOXX)	0601083508	£1,530.32	£1,836.38

# MEASURING TOOLS AS ROBUST AS THEY ARE

Inspired by you: Robust measuring tools from Bosch Professional.

## Tough Measuring Tools inspired by the toughest tradespeople.

If you want to prove yourself on the construction site you have to be tough. That also applies to your tools.

Whether during transport or in use – falls, water, dust and mud won't slow you down. Work without compromise with precise Measuring Tools that are as tough as you are.

**PRECISE.**



**Impact resistance**



**Water and dust protection**



**Impressive accuracy**

# DUST CONTROL: SIMPLE EXISTS

Protect your health, your tools, your accessories.  
It's easier than you think.

Bosch Professional



# WHY DUST CONTROL MATTERS

Dust is on every jobsite, yet its harmful effects are often underestimated. This is why we've made our dust solutions simple. We designed them to remove harmful dust particles as you work without reducing your performance, so you can protect your health, tools and accessories while staying productive.



## RIGHT SOLUTIONS FOR ANY APPLICATION

We got what you need for your protection – from dust extractors to dust attachments to dust-ready tools. With us, you can find the right dust solution for nearly any application and material you can think of.

## EASY TO USE

From dust-ready tools to dust attachments that fit perfectly on your tools, all our dust solutions make it easy for you to get dust under control. Our solutions are designed to extract dust exactly at the drilling, chiselling, cutting, sanding, or grinding point, before the dust can go airborne.



## PERFORMANCE UNCOMPROMISED

Our dust solutions make hard work easier, not harder. We test and design all our dust control solutions so that they don't interfere with the quality of your work. All parts are designed to work together as one system to keep the air, your tools and working surface clean.

# PARTICLE

## EXPERT SDS Clean plus-8X and max-8X

### Removable Dust Extractor Pipe

Robust steel pipe is easy to clean if it clogs



### PGM Certification

Guarantees the precision of the diameters drilled by the SDS Clean drill bit

### Bosch Welding Technology

Highly resistant drill bit connection



Range Plus:  $\varnothing$  12 – 20mm  
Range Max:  $\varnothing$  20 – 32mm

### 4-Cutter Full Carbide Head

Punches through reinforced concrete and reduces jamming

### Connector SDS Clean

Changing drill bits is easy. Compact design helps save storage space

### Certification

Included in BG Bau white list and certification for Würth & Fischer chemical anchors is ongoing

## EXPERT M480

### 1 Protect your health

By removing harmful dust particles as you work, our dust solutions make sure you can breathe easy and work comfortably all day.

### 3 Protect your accessories

Dust can clog up your accessories and wear them out fast. Save time and money. When you use dust control you make your accessories last even longer.

### 2 Protect your tools

Dust gets inside your tools, accelerating tool wear and tear. Our dust solutions protect your tools from dust, so you get longer lifetimes and better performance.

### 4 Achieve compliance

Our dust solutions fulfil established health and safety regulations, and our dust extractors are visibly certified – so you can achieve compliance the easy way.

# CONTROL

## EXPERT SDS Clean Adapter for Drilling

### Fits Different Drilling Jobs

Overhead drilling and serial hole drilling

### Universal Fit

Fits most vacuum cleaners

**UP TO 25x\***



**DUST REDUCTION**



### Particle Control

Up to 25x better dust reduction

### Vacuum Hose Handle

Better handling

Fits SDS-plus drill bits  
Ø 5 – 16mm

**PARTICLE CONTROL**



# PRO DEALS

For more  
information and  
other great  
deals:  
[www.pro360.com/prodeals](http://www.pro360.com/prodeals)



## GRAB YOURS NOW!

PRO Deals, you can upgrade your tool bag with new and useful rewards every season. Redeeming rewards is easy and only takes a few clicks. Check out all available PRO Deals now: [www.pro360.com/prodeals](http://www.pro360.com/prodeals).

Only valid from May to August 2024 and while stocks last!



Rewards available while stocks last. Terms and conditions apply: [www.pro360.com/prodeals/termsandconditions](http://www.pro360.com/prodeals/termsandconditions)  
Participation per purchase limited to one promotion only. **Valid May to August 2024**

## FREE 18V BATTERY OR DUST CONTROL SOLUTION

### When you buy one 18V Tool or Kit

Buy one 18V tool or kit over £199.00 (inc. VAT) and get a free ProCORE18V 4.0Ah battery or a Dust Control solution: GDE 18V-16, GDE 125 EA-T, GDE 68, GDE 18V-12, GDE 115/125 FC-T.





# FREE LEVELLING ACCESSORY

## When you buy one levelling tool

Buy one Bosch Professional levelling tool and get a suitable accessory out of a defined range free of charge.



# EXPAND YOUR TOOLBOX

## Buy accessories get one accessory or branded item for free

Spend **£66.00 (inc. VAT)** or more on Bosch Power Tool Accessories and get one EXPERT accessory or branded product **from category A** free.

Spend **£132.00 (inc. VAT)** or more and get one EXPERT accessory or branded product **from category A or B** free. Must be a single purchase.

### Category A

Purchase of £66.00 (Inc VAT) or more



### Category B

Purchase of £132.00 (inc VAT) or more



# TECH AND TIPS ON BOSCH TOOLS



**Bosch Professional UK HQ are livestreaming every other Wednesday at 5PM GMT!**

With 20+ successful livestreams and over 290,000 views, the community continues to grow! Covering topics such as new tools, the EXPERT accessory range, laser levels and so much more.

The livestreams are a place for you to directly communicate with our professional team, with dedicated Q&As to make your voice heard throughout each stream.

Visit our YouTube channel to join the livestreams, learn more about our tools and accessories and discover the latest safety innovations found in our products.



Bosch Pro UK is now on YouTube Shorts, with bite-sized videos packed with tips, tricks, and product demos to help you get the job done right.

**You won't want to miss these!**

**@BoschProUK**

**@BoschProfessionalPowerToolsUK**

**@BoschProfessionalPowerToolsUK**



# BOSCH ON SITE

**Our team is hitting the road!**



You can receive a worksite visit from a Bosch Professional van full of innovative Power Tools, Measuring Tools and Accessories, everything for you to test. Our team will give you top tips and tricks, to get the most out of Bosch Professional Power Tools, Measuring Tools and Accessories.



## It's so easy!

Simply request a visit on our website, and you can have the chance to get a visit from our friendly experts.

**Scan to find out more!**



PART NUMBER	PRODUCT TYPE	DESCRIPTION	BOSCH LIST PRICE (EX. VAT)
06019H2170	Screwdriver	Bosch GO /25pcs Acc Set, 1 PH2, charger adapter, USB cable, L-BOXX mini) 3.6V Screwdriver	£72.27
0601868101	Drill Driver	GSR 12V-15 (body only, carton) 12V D/Driver	£76.57
060186817A	Drill Driver	GSR 12V-15 (2x GBA 2.0Ah, GAL 12V-20, Tool Bag) 12V D/Driver	£139.71
06019F6002	Drill Driver FlexiClick	GSR 12V-15 FC (body only, GFA 12 B attachment, L-BOXX) 12V D/Driver	£125.36
06019F6071	Drill Driver FlexiClick	GSR 12V-15 FC (2x GBA 2.0Ah, GAL 12V-40, GFA 12-B attachment, L-BOXX) 12V D/Driver	£169.31
06019F6070	Drill Driver FlexiClick	GSR 12V-15 FC (2x GBA 2.0Ah, GAL 12V-40, GFA 12-B/E/W/X attachments, L-BOXX) 12V D/Driver	£237.94
06019H8000	Drill Driver	GSR 12V-35 (body only, carton) BRUSHLESS 12V D/Driver	£114.77
06019H8001	Drill Driver	GSR 12V-35 (body only, L-BOXX) BRUSHLESS 12V D/Driver	£131.05
06019H8070	Drill Driver	GSR 12V-35 (2x GBA 3.0Ah, GAL 12V-40, L-BOXX) BRUSHLESS 12V D/Driver	£223.04
06019H3004	Drill Driver FlexiClick	GSR 12V-35 FC (body only, carton) BRUSHLESS 12V D/Driver	£117.22
06019H3002	Drill Driver FlexiClick	GSR 12V-35 FC (body only, GFA-12 B attachment, L-BOXX) BRUSHLESS 12V D/Driver	£153.65
06019H3003	Drill Driver FlexiClick	GSR 12V-35 FC (body only, GFA 12-B/E/W/X attachments, L-BOXX) BRUSHLESS 12V D/Driver	£227.30
06019H300B	Drill Driver	GSR 12V-35 FC (body only, GFA 12-H, Aux Handle, Depth Gauge attachments, L-BOXX) BRUSHLESS 12V D/Driver	£245.00
06019J9103	Drill Driver	GSR 12V-35 HX (body only, carton) 12V D/Driver	£122.61
06019J9170	Drill Driver	GSR 12V-35 HX (2x GBA 3.0Ah, GAL 12V-40, L-BOXX) 12V D/Driver	£226.51
1600A00F5H	Attachment FlexiClick	GFA 12-B Chuck Attachment (carton) 12V FlexiClick Attachment	£30.93
1600A00F5L	Attachment FlexiClick	GFA 12-E Off-Centre Angle Attachment (carton) 12V FlexiClick Attachment	£30.93
1600A024LN	Attachment FlexiClick	GFA 12-H (Aux Handle, Depth Gauge, carton) 12V SDS Attachment	£106.10
1600A00F5K	Attachment FlexiClick	GFA 12-W Right Angle Attachment (carton) 12V FlexiClick Attachment	£30.93
1600A00F5J	Attachment FlexiClick	GFA 12-X Bitholder Attachment (carton) 12V FlexiClick Attachment	£20.35
06019E4002	Screw Gun	GTB 12V-11 (body only, carton) BRUSHLESS 12V S/Gun	£117.22
06019K7000	Screw Gun	GTB 18V-45 (body only, carton) BRUSHLESS 18V Drywall Screwdriver	£170.28
06019K7005	Screw Gun	GTB 18V-45 (body only, GMA-55 attachment, carton) BRUSHLESS 18V Drywall Screwdriver	£245.52
1600A025GD	Attachment	GMA 55 (body only, PH2 bit, carton) Collated Screw Attachment	£87.10
06019H4100	Drill Driver	GSR 18V-28 (body only, carton) 18V D/Driver	£125.65
06019K3200	Drill Driver	GSR 18V-45 (body only, carton) BRUSHLESS 18V D/Driver	£103.95
06019K3201	Drill Driver	GSR 18V-45 (body only, L-BOXX) BRUSHLESS 18V D/Driver	£144.00
06019H5202	Drill Driver	GSR 18V-55 (body only, carton) BRUSHLESS 18V D/Driver	£143.90
06019H5203	Drill Driver	GSR 18V-55 (body only, L-BOXX) BRUSHLESS 18V D/Driver	£165.00
06019K6000	Drill Driver	GSR 18V-90 C (body only, carton) BRUSHLESS 18V D/Driver	£142.30
06019K6002	Drill Driver	GSR 18V-90 C (body only, L-BOXX) BRUSHLESS 18V D/Driver	£201.00
06019K6071	Drill Driver	GSR 18V-90 C (2x GBA 4.0Ah, GAL 18V-40, L-BOXX) BRUSHLESS 18V D/Driver	£305.00

PART NUMBER	PRODUCT TYPE	DESCRIPTION	BOSCH LIST PRICE (EX. VAT)
06019K6202	Drill Driver FlexiClick	GSR 18V-90 FC (body only, carton) BRUSHLESS 18V D/Driver	£219.12
06019K6203	Drill Driver FlexiClick	GSR 18V-90 FC (body only, GFA 18-M, GFA 18-W, GFA 18-E, L-BOXX) BRUSHLESS 18V D/Driver	£329.00
06019K6204	Drill Driver FlexiClick	GSR 18V-90 FC (body only, GFA 18-M, GFA 18-H, Aux Handle, Depth Gauge, L-BOXX) BRUSHLESS 18V D/Driver	£357.00
06019G0109	Drill Driver	GSR 18V-110 C (body only, L-BOXX) BRUSHLESS 18V D/Driver	£219.00
06019J5001	Drill Driver	GSR 18V-150 C (body only, carton) BITURBO BRUSHLESS 18V D/Driver	£254.59
06019J5002	Drill Driver	GSR 18V-150 C (body only, L-BOXX) BITURBO BRUSHLESS 18V D/Driver	£275.21
1600A001SJ	Attachment FlexiClick	GFA 18-E Off-Centre Angle Attachment (carton) 18V FlexiClick Attachment	£63.49
1600A003NF	Attachment FlexiClick	GFA 18-H SDS Hammer Attachment (carton) 18V FlexiClick Attachment	£114.84
1600A013P6	Attachment FlexiClick	GFA 18-M Metal Chuck Attachment (carton) 18V FlexiClick Attachment	£63.49
1600A013P7	Attachment FlexiClick	GFA 18-W Angle Hex Attachment (carton) 18V FlexiClick Attachment	£63.49
1600A02EP6	Attachment FlexiClick	GFA 18-WM Metal Angle Chuck Attachment (carton) 18V FlexiClick Attachment	£70.49
06019B6901	Combi	GSB 12V-15 (body only, carton) 12V Combi	£90.50
06019B697J	Combi	GSB 12V-15 (2x GBA 2.0Ah, GAL 12V-20, Tool Bag) 12V Combi	£148.45
06019B697K	Combi	GSB 12V-15 (1x GBA 2.0Ah, 1x GBA 4.0Ah, GAL 12V-20, 39 accessories, Tool Bag) 12V Combi	£168.50
06019J9002	Combi	GSB 12V-35 (body only, carton) 12V Combi	£121.18
06019J9070	Combi	GSB 12V-35 (2x GBA 3.0Ah, GAL 12V-40, L-BOXX) 12V Combi	£226.51
06019H1176	Combi	GSB 18V-21 (body only, carton) 18V Combi	£109.80
06019H1108	Combi	GSB 18V-21 (body only, L-BOXX) 18V Combi	£129.88
06019H4000	Combi	GSB 18V-28 (body only, carton) 18V Combi	£135.24
06019H4008	Combi	GSB 18V-28 (body only, L-BOXX) 18V Combi	£155.32
06019K3300	Combi	GSB 18V-45 (body only, carton) BRUSHLESS 18V Combi	£103.95
06019K3301	Combi	GSB 18V-45 (body only, L-BOXX) BRUSHLESS 18V Combi	£150.00
06019K3371	Combi	GSB 18V-45 (2x GBA 2.0Ah, GAL 18V-20, L-BOXX) BRUSHLESS 18V Combi	£129.99
06019H5302	Combi	GSB 18V-55 (body only, carton) BRUSHLESS 18V Combi	£148.05
06019H5303	Combi	GSB 18V-55 (body only, L-BOXX) BRUSHLESS 18V Combi	£170.00
06019H5370	Combi	GSB 18V-55 (2x GBA 2.0Ah, GAL 18V-40, L-BOXX) BRUSHLESS 18V Combi	£178.16
06019H5372	Combi	GSB 18V-55 (2x CoreCORE 18V 4.0Ah, GAL 18V-40, L-BOXX) BRUSHLESS 18V Combi	£253.69
06019K6100	Combi	GSB 18V-90 C (body only, carton) BRUSHLESS 18V Combi	£142.30
06019K6102	Combi	GSB 18V-90 C (body only, L-BOXX) BRUSHLESS 18V Combi	£209.00
06019K6171	Combi	GSB 18V-90 C (2x GBA 4.0Ah, GAL 18V-40, L-BOXX) BRUSHLESS 18V Combi	£285.30
06019G0309	Combi	GSB 18V-110 C (body only, carton) BRUSHLESS 18V Combi	£205.10
06019G030A	Combi	GSB 18V-110 C (body only, L-BOXX) BRUSHLESS 18V Combi	£224.95

PART NUMBER	PRODUCT TYPE	DESCRIPTION	BOSCH LIST PRICE (EX. VAT)
06019G0376	Combi	GSB 18V-110 C (2x ProCORE18V 4.0Ah, GAL 18V-40, L-BOXX) BRUSHLESS 18V Combi	£423.11
06019J5101	Combi	GSB 18V-150 C (body only, carton) BITURBO BRUSHLESS 18V Combi	£261.47
06019J5102	Combi	GSB 18V-150 C (body only, L-BOXX) BITURBO BRUSHLESS 18V Combi	£340.89
06019J5172	Combi	GSB 18V-150 C (2x ProCORE18V 8.0Ah, GAL 1880 CV, L-BOXX) BITURBO BRUSHLESS 18V Combi	£673.51
06019A6901	Impact Driver	GDR 12V-105 (body only, carton) 12V I/Driver	£93.98
06019A6976	Impact Driver	GDR 12V-105 (2x GBA 2.0Ah, GAL 1230 CV, L-BOXX) 12V I/Driver	£210.83
06019E0002	Impact Driver	GDR 12V-110 (body only, carton) BRUSHLESS 12V I/Driver	£131.47
06019G5104	Impact Driver	GDR 18V-160 (body only, L-BOXX) 18V I/Driver	£125.00
06019J2105	Impact Driver	GDR 18V-200 (body only, carton) BRUSHLESS 18V I/Driver	£139.98
06019J2106	Impact Driver	GDR 18V-200 (body only, L-BOXX) BRUSHLESS 18V I/Driver	£164.00
06019J2172	Impact Driver	GDR 18V-200 (2x GBA 5.0Ah, GAL 18V-40, L-CASE) BRUSHLESS 18V I/Driver	£315.02
06019J0100	Impact Driver	GDR 18V-210 C (body only, carton) BRUSHLESS 18V I/Driver	£188.03
06019J0101	Impact Driver	GDR 18V-210 C (body only, L-BOXX) + GCY 42 (CoMo) BRUSHLESS 18V I/Driver	£216.22
06019L6000	Impact Driver	GDR 18V-220 C (body only, carton) BRUSHLESS 18V I/Driver	£193.12
06019L6001	Impact Driver	GDR 18V-220 C (body only, L-BOXX) + GCY 42 (CoMo) BRUSHLESS 18V I/Driver	£228.23
06019J2204	Impact Driver / Wrench	GDX 18V-200 (body only, carton) BRUSHLESS 18V I/D/Wrench	£145.12
06019J2205	Impact Driver / Wrench	GDX 18V-200 (body only, L-BOXX) BRUSHLESS 18V I/D/Wrench	£172.00
06019J2272	Impact Driver / Wrench	GDX 18V-200 (2x GBA 5.0Ah, GAL 18V-40, L-CASE) BRUSHLESS 18V I/D/Wrench	£331.30
06019J0200	Impact Driver / Wrench	GDX 18V-210 C (body only, carton) BRUSHLESS 18V I/D/Wrench	£197.21
06019J0201	Impact Driver / Wrench	GDX 18V-210 C (body only, L-BOXX) + GCY 42 (CoMo) BRUSHLESS 18V I/D/Wrench	£226.51
06019E0101	Impact Wrench	GDS 12V-115 (body only, carton) BRUSHLESS 12V I/Wrench	£131.47
06019J0300	Impact Wrench	GDS 18V-210 C (body only, carton) BRUSHLESS 18V I/Wrench	£188.03
06019J0301	Impact Wrench	GDS 18V-210 C (body only, L-BOXX) + GCY 42 (CoMo) BRUSHLESS 18V I/Wrench	£216.22
06019L5100	Impact Wrench	GDS 18V-320 C (body only, carton) BRUSHLESS 18V I/Wrench	£208.16
06019L5000	Impact Wrench	GDS 18V-330 HC (body only, carton) 18V I/Wrench	£213.84
06019L5001	Impact Wrench	GDS 18V-330 HC (body only, L-BOXX) 18V I/Wrench	£231.44
06019L5071	Impact Wrench	GDS 18V-330 HC (2x 4.0Ah, GAL 18V-40, L-BOXX) 18V I/Wrench	£412.00
06019K4000	Impact Wrench	GDS 18V-450 HC (carton) BRUSHLESS 18V I/Wrench	£221.76
06019K4001	Impact Wrench	GDS 18V-450 HC (L-BOXX) + GCY 42 (CoMo) BRUSHLESS 18V I/Wrench	£251.86
06019K4100	Impact Wrench	GDS 18V-450 PC (body only, carton) BRUSHLESS I/Wrench	£221.76
06019K4101	Impact Wrench	GDS 18V-450 PC (body only, L-BOXX) BRUSHLESS I/Wrench	£251.86
06019K4170	Impact Wrench	GDS 18V-450 PC (2x 4.0Ah ProCORE18V, GAL 18V-40, Como, L-BOXX) BRUSHLESS I/Wrench	£436.39

PART NUMBER	PRODUCT TYPE	DESCRIPTION	BOSCH LIST PRICE (EX. VAT)
06019J8300	Impact Wrench	GDS 18V-1000 (body only, carton) BITURBO BRUSHLESS 18V High Torque I/Wrench ½"	£283.52
06019J8301	Impact Wrench	GDS 18V-1000 (body only, L-BOXX) BITURBO BRUSHLESS 18V High Torque I/Wrench ½"	£289.87
06019J8371	Impact Wrench	GDS 18V-1000 (2x ProCORE18V 5.5Ah, GAL 18V-40, L-BOXX) BITURBO BRUSHLESS 18V High Torque I/Wrench ½"	£573.06
06019J8370	Impact Wrench	GDS 18V-1000 (2x ProCORE18V 8.0Ah, GAL 18V-40, L-BOXX) BITURBO BRUSHLESS 18V High Torque I/Wrench ½"	£596.66
06019J8000	Impact Wrench	GDS 18V-1000 C (body only, carton) + GCY 42 (CoMo) BITURBO BRUSHLESS 18V High Torque I/Wrench ½"	£285.71
06019J8001	Impact Wrench	GDS 18V-1000 C (body only, L-BOXX) + GCY 42 (CoMo) BITURBO BRUSHLESS 18V High Torque I/Wrench ½"	£319.90
06019J8071	Impact Wrench	GDS 18V-1000 C (2x ProCORE18V 5.5Ah, GAL 1880 CV, L-BOXX) + GCY 42 (CoMo) BITURBO BRUSHLESS 18V High Torque I/Wrench ½"	£581.20
06019J8070	Impact Wrench	GDS 18V-1000 C (2x ProCORE18V 8.0Ah, GAL 1880 CV, L-BOXX) + GCY 42 (CoMo) BITURBO BRUSHLESS 18V High Torque I/Wrench ½"	£603.99
06019J8500	Impact Wrench	GDS 18V-1050 H (body only, carton) BITURBO BRUSHLESS 18V High Torque I/Wrench ¾"	£277.57
06019J8501	Impact Wrench	GDS 18V-1050 H (body only, L-BOXX) BITURBO BRUSHLESS 18V High Torque I/Wrench ¾"	£289.87
06019J8200	Impact Wrench	GDS 18V-1050 HC (body only, carton) + GCY 42 (CoMo) BITURBO BRUSHLESS 18V High Torque I/Wrench ¾"	£285.71
06019J8201	Impact Wrench	GDS 18V-1050 HC (body only, L-BOXX) + GCY 42 (CoMo) BITURBO BRUSHLESS 18V High Torque I/Wrench ¾"	£319.90
06019M1000	Impact Wrench	GDS 18V-1600 HC (body only, carton) BITURBO BRUSHLESS 18V High Torque I/Wrench ¾"	£306.06
06019M1001	Impact Wrench	GDS 18V-1600 HC (body only, L-BOXX) + GCY 42 (CoMo) BITURBO BRUSHLESS 18V High Torque I/Wrench ¾"	£341.07
06019M1070	Impact Wrench	GDS 18V-1600 HC (2x ProCORE18V 8.0Ah, GAL 1880 CV, L-BOXX) + GCY 42 (CoMo) BITURBO BRUSHLESS 18V High Torque I/Wrench ¾"	£634.92
0601390905	Angle Drill	GWB 12V-10 (body only, carton) 12V A/Drill	£108.26
0601390909	Angle Drill	GWB 12V-10 (body only, L-BOXX) 12V A/Drill	£124.54
0611924000	SDS-Plus	GBH 18V-22 (body only, carton) BRUSHLESS SDS-Plus	£197.21
0611924001	SDS-Plus	GBH 18V-22 (body only, L-BOXX) BRUSHLESS SDS-Plus	£217.01
0611924004	SDS-Plus	GBH 18V-22 (GDE 18V-12, L-BOXX) BRUSHLESS SDS-Plus	£236.81
0611924072	SDS-Plus	GBH 18V-22 (2x GBA 4.0Ah, GAL 18V-40, carry case) BRUSHLESS SDS-Plus	£361.15
1600A028H6	Attachment	GDE 18V-12 (body only, carton) Dust Attachment	£62.57
0611923000	SDS-Plus	GBH 18V-24 C (body only, carton) BRUSHLESS 18V SDS-Plus	£243.39
0611923001	SDS-Plus	GBH 18V-24 C (body only, L-BOXX) BRUSHLESS 18V SDS-Plus	£259.78
0611923073	SDS-Plus	GBH 18V-24 C kit (2 x 5.0Ah, GAL 1880, L-BOXX) BRUSHLESS 18V SDS-Plus	£434.02
0611909000	SDS-Plus	GBH 18V-26 (body only, carton) BRUSHLESS 18V SDS-Plus	£274.32

PART NUMBER	PRODUCT TYPE	DESCRIPTION	BOSCH LIST PRICE (EX. VAT)
0611909001	SDS-Plus	GBH 18V 26 D (body only, L-BOXX) BRUSHLESS 18V SDS-Plus	€316.97
0611916001	SDS-Plus	GBH 18V 26 D (body only, carton) BRUSHLESS 18V SDS-Plus	€219.78
0611910000	SDS-Plus	GBH 18V 26 F (body only, carton) BRUSHLESS 18V SDS-Plus	€344.64
0611910073	SDS-Plus	GBH 18V 26 F (2x GBA 5.0Ah, GAL 1880 CV, L-BOXX) BRUSHLESS 18V SDS-Plus	€501.20
0611910078	SDS-Plus	GBH 18V 26 F (2x ProCORE18V 8.0Ah, GAL 1880 CV, L-BOXX) BRUSHLESS 18V SDS-Plus	€632.81
0611920000	SDS-Plus	GBH 18V 28 C (body only, carton) BRUSHLESS 18V SDS-Plus	€351.12
0611920001	SDS-Plus	GBH 18V 28 C (body only, L-BOXX) BRUSHLESS 18V SDS-Plus	€379.30
0611921001	SDS-Plus	GBH 18V 28 CF (body only, L-BOXX) BRUSHLESS 18V SDS-Plus	€409.20
0611921075	SDS-Plus	GBH 18V 28 CF (2x ProCORE18V 5.5Ah, GAL 1880 CV, L-BOXX) BRUSHLESS 18V SDS-Plus	€751.72
0611919000	SDS-Plus	GBH 18V 28 DC (body only, carton) BRUSHLESS 18V SDS-Plus	€304.44
0611914001	SDS-Plus	GBH 18V 34 CF (body only, carry case) BITURBO BRUSHLESS 18V SDS-Plus	€576.33
0611914073	SDS-Plus	GBH 18V 34 CF (2x ProCORE18V 5.5Ah, GAL 1880 CV, carry case) BITURBO BRUSHLESS 18V SDS-Plus	€819.72
0611914072	SDS-Plus	GBH 18V 34 CF (2x ProCORE18V 8.0Ah, GAL 1880 CV, carry case) BITURBO BRUSHLESS 18V SDS-Plus	€894.59
1600A0051M	Attachment	GDE 18V-16 (carton) 18V Dust Attachment	€128.17
1600A01TX0	Attachment	GDE 18V-26 D (carton) 18V Dust Attachment	€92.80
1600A021BH	Attachment	GDE 28 D (carton) Dust Attachment	€49.65
0611915001	SDS-Max	GBH 18V 36 C (body only, carry case) BITURBO BRUSHLESS 18V SDS-Max	€587.71
0611915073	SDS-Max	GBH 18V 36 C (2x ProCORE18V 5.5Ah, GAL 1880 CV, carry case) BITURBO BRUSHLESS 18V SDS-Max	€862.84
0611915072	SDS-Max	GBH 18V 36 C (2x ProCORE18V 8.0Ah, GAL 1880 CV, carry case) BITURBO BRUSHLESS 18V SDS-Max	€915.75
0611917100	SDS-Max	GBH 18V 40 C (body only, carry case) BITURBO BRUSHLESS 18V SDS-Max	€694.58
0611917172	SDS-Max	GBH 18V 40 C (2x ProCORE18V 8.0Ah, GAL 1880 CV, carry case) BITURBO BRUSHLESS 18V SDS-Max	€1,013.76
0611913000	SDS-Max	GBH 18V 45 C (body only, carry case) + GCY 42 (CoMo) BITURBO BRUSHLESS 18V SDS-Max	€877.49
0611913072	SDS-Max	GBH 18V 45 C (2x ProCORE18V 12.0Ah, GAL 18V-160 C, carry case) + GCY 42 (CoMo) BITURBO BRUSHLESS 18V SDS-Max	€1,324.22
06016A1001	Circular Saw	GKS 12V-26 (body only, carton) 12V C/Saw	€117.88
06016A1002	Circular Saw	GKS 12V-26 (body only, L-BOXX) 12V C/Saw	€135.94
06016A1070	Circular Saw	GKS 12V-26 (2x GBA 2.0Ah, GAL 1230 CV, L-BOXX) 12V C/Saw	€217.34
06016A2101	Circular Saw	GKS 18V-57 G (body only, L-BOXX) 18V C/Saw	€220.97
06016C1200	Circular Saw	GKS 18V-57-2 (body only, carton) 18V C/Saw	€214.08
06016C1201	Circular Saw	GKS 18V-57-2 (body only, L-BOXX) 18V C/Saw	€236.02
06016C1100	Circular Saw	GKS 18V-57-2 L (body only, carton) C/Saw	€214.08
06016C1101	Circular Saw	GKS 18V-57-2 L (body only, L-BOXX) C/Saw	€236.02
06016B5000	Circular Saw	GKS 18V-68 C (body only, carton) BITURBO BRUSHLESS 18V C/Saw	€312.05

PART NUMBER	PRODUCT TYPE	DESCRIPTION	BOSCH LIST PRICE (EX. VAT)
06016B5001	Circular Saw	GKS 18V-68 C (body only, L-BOXX) BITURBO BRUSHLESS 18V C/Saw	€339.77
06016B5070	Circular Saw	GKS 18V-68 C (1x ProCORE18V 5.5Ah, GAL 1880 CV, L-BOXX) + GCY 42 (CoMo) BITURBO BRUSHLESS 18V C/Saw	€531.43
06016B5100	Circular Saw	GKS 18V-68 GC (body only, L-BOXX) BITURBO BRUSHLESS 18V C/Saw	€381.74
06016B9000	Circular Saw	GKS 18V-70 L (body only, carton) BITURBO BRUSHLESS 18V Circular Saw	€360.60
06016B9001	Circular Saw	GKS 18V-70 L (body only, L-BOXX) BITURBO BRUSHLESS 18V Circular Saw	€380.95
06016B8000	Metal Saw	GKM 18V-50 (body only, carton) 18V M/Saw	€236.81
06016B8001	Metal Saw	GKM 18V-50 (body only, L-BOXX) 18V M/Saw	€264.53
06016B4000	Plunge Saw	GKT 18V-52 GC (body only, L-BOXX) + GCY 42 (CoMo) BITURBO BRUSHLESS 18V P/Saw	€430.93
0601B44000	Table Saw	GTS 18V-216 (body only, carton) BITURBO BRUSHLESS 18V T/Saw	€721.20
0601B41000	Mitre Saw	GCM 18V-216 (body only, carton) BITURBO BRUSHLESS 18V M/Saw	€491.04
0601B51000	Mitre Saw	GCM 18V-216 D (body only, carton) BITURBO BRUSHLESS 18V M/Saw	€491.92
0601B47000	Mitre Saw	GCM 18V-216 DC (body only, carton) BITURBO BRUSHLESS 18V M/Saw	€692.08
0601B51100	Mitre Saw	GCM 18V-254 D (body only, carton) BITURBO BRUSHLESS 18V M/Saw	€667.92
0601B43000	Mitre Saw	GCM 18V-305 GDC (body only, carton) BITURBO BRUSHLESS 18V M/Saw	€1,079.50
06015A1001	Jig Saw	GST 12V-70 (body only, carton) 12V J/Saw	€108.60
06015A1070	Jig Saw	GST 12V-70 (2x GBA 2.0Ah, GAL 1230 CV, L-BOXX) 12V J/Saw	€228.78
06015A6100	Jig Saw	GST 18V-11 B (body only, carton) 18V J/Saw	€192.43
06015A6101	Jig Saw	GST 18V-11 B (body only, L-BOXX) 18V J/Saw	€211.29
06015B3001	Jig Saw	GST 18V-125 B (body only, carton) BRUSHLESS 18V Jig Saw	€204.16
06015B3000	Jig Saw	GST 18V-125 B (body only, L-BOXX) BRUSHLESS 18V Jig Saw	€209.20
06015B1001	Jig Saw	GST 18V-155 BC (body only, carton) + GCY 42 (CoMo) 18V J/Saw	€247.46
06015B1000	Jig Saw	GST 18V-155 BC (body only, L-BOXX) + GCY 42 (CoMo) 18V J/Saw	€266.99
06015A5100	Jig Saw	GST 18V-11 S (body only, carton) 18V J/Saw	€192.43
06015B2001	Jig Saw	GST 18V-125 S (body only, carton)	€204.16
06015B2000	Jig Saw	GST 18V-125 S (body only, L-BOXX)	€226.16
06015A5101	Jig Saw	GST 18V-11 S (body only, L-BOXX) 18V J/Saw	€187.22
06015B0001	Jig Saw	GST 18V-155 SC (body only, carton) + GCY 42 (CoMo) 18V J/Saw	€247.46
06015B0000	Jig Saw	GST 18V-155 SC (body only, L-BOXX) + GCY 42 (CoMo) 18V J/Saw	€281.12
060164L902	Reciprocating Saw	GSA 12V-14 (body only, carton) 12V R/Saw	€110.09
060164J007	Reciprocating Saw	GSA 18V-11 (body only, L-BOXX) 18V R/Saw	€209.87
060164J077	Reciprocating Saw	GSA 18V-11 (2x GBA 5.0Ah, GAL 1880 CV, L-BOXX) 18V R/Saw	€413.04
06016A5001	Reciprocating Saw	GSA 18V-11 C (body only, L-BOXX) 18V R/Saw	€163.15
06016C0000	Reciprocating Saw	GSA 18V-28 (body only, carton) BITURBO BRUSHLESS 18V R/Saw	€231.18
06016C0001	Reciprocating Saw	GSA 18V-28 (body only, L-BOXX) BITURBO BRUSHLESS 18V R/Saw	€286.50
06016A8108	Reciprocating Saw	GSA 18V-32 (body only, carton) BRUSHLESS 18V R/Saw	€358.19

PART NUMBER	PRODUCT TYPE	DESCRIPTION	BOSCH LIST PRICE (EX. VAT)
06016A8109	Reciprocating Saw	GSA 18V-32 (body only, carry case) BRUSHLESS 18V R/Saw	£305.25
06012A0400	Band Saw	GCB 18V-63 (body only, carton) 18V B/Saw	£200.24
06012A0401	Band Saw	GCB 18V-63 (body only, L-BOXX) 18V B/Saw	£228.73
06012B7000	Band Saw	GCB 18V-127 (body only, carton) 18V B/Saw	£471.50
06018B5001	Multi Cutter	GOP 12V-28 (body only, 1x blade, carton) BRUSHLESS Starlock Plus / Starlock 12V M/Cutter	£119.76
06018B5002	Multi Cutter	GOP 12V-28 (body only, 1x blade, L-BOXX) BRUSHLESS Starlock Plus / Starlock 12V M/Cutter	£133.06
06018B6002	Multi Cutter	GOP 18V-28 (body only, 1x blade, carton) BRUSHLESS Starlock Plus / Starlock 18V M/Cutter	£202.70
06018B6001	Multi Cutter	GOP 18V-28 (body only, 1x blade, L-BOXX) BRUSHLESS Starlock Plus / Starlock 18V M/Cutter	£221.55
06018G2001	Multi Cutter	GOP 18V-34 (body only, 1x blade, carton) BRUSHLESS Starlock Plus / Starlock 18V M/Cutter	£203.98
06018G2000	Multi Cutter	GOP 18V-34 (body only, 1x blade, L-BOXX) BRUSHLESS Starlock Plus / Starlock 18V M/Cutter	£224.05
06018G2002	Multi Cutter	GOP 18V-34 (body only, 16 accessories, L-BOXX) BRUSHLESS Starlock Plus / Starlock 18V M/Cutter	£281.73
06015A7070	Planer	GHO 12V-20 (body only, carton) BRUSHLESS 12V Planer	£211.46
06015A7072	Planer	GHO 12V-20 (body only, L-BOXX) BRUSHLESS 12V Planer	£234.43
06015A0300	Planer	GHO 18V-LI (body only, L-BOXX) 18V Planer	£221.13
06015B5001	Planer	GHO 18V-26 (body only, carton, 1x extra blade, 1x parallel guide, 1x dust bag) BRUSHLESS 18V Planer	£227.39
06015B5000	Planer	GHO 18V-26 (body only, L-BOXX, 1x extra blade, 1x parallel guide, 1x dust bag) BRUSHLESS 18V Planer	£260.83
06019L0001	Orbital Sander	GSS 12V-13 (body only, rectangular, squared and delta plates, L-BOXX) BRUSHLESS 12V O/Sander	£180.58
06019D0200	Orbital Sander	GSS 18V-10 (body only, carton) 18V O/Sander	£137.81
06019D0202	Orbital Sander	GSS 18V-10 (body only, L-BOXX) 18V O/Sander	£173.45
06019L0101	Orbital Sander	GSS 18V-13 (body only, rectangular, squared and delta plates, L-BOXX) BRUSHLESS 18V O/Sander	£223.40
0601372101	Random Orbital Sander	GEX 12V-125 (body only, carton) BRUSHLESS 12V RO/Sander	£133.06
0601372100	Random Orbital Sander	GEX 12V-125 (body only, L-BOXX) BRUSHLESS 12V RO/Sander	£152.86
0601372201	Random Orbital Sander	GEX 18V-125 (body only, carton) BRUSHLESS 18V RO/Sander	£175.03
0601372200	Random Orbital Sander	GEX 18V-125 (body only, L-BOXX) BRUSHLESS 18V RO/Sander	£194.83
06016B0072	Router	GKF 12V-8 (body only, carton) BRUSHLESS 12V Router	£167.51
06016B0070	Router	GKF 12V-8 (2x GBA 3.0Ah, GAL 1230 CV, L-BOXX) BRUSHLESS 12V Router	£286.70
06019C5000	Rotary Tool	GRO 12V-35 (body only, mandrel, 5x cutting wheels, carton) 12V R/Tool	£97.42
06019C5070	Rotary Tool	GRO 12V-35 (2x GBA 2.0Ah, GAL 1230 CV, mandrel, 5x cutting wheels, L-BOXX) 12V R/Tool	£201.87
06019F2070	Angle Grinder	GWS 12V-76 V-EC (body only, 3x cutting discs, carton) BRUSHLESS 12V A/Grinder	£129.68
06019H9003	Angle Grinder	GWS 18V-7 115mm (body only, carton) A/Grinder	£143.33

PART NUMBER	PRODUCT TYPE	DESCRIPTION	BOSCH LIST PRICE (EX. VAT)
06019H9004	Angle Grinder	GWS 18V-7 115mm (body only, L-BOXX) A/Grinder	£162.18
06019H9070	Angle Grinder	GWS 18V-7 115mm (2x GBA 4.0Ah, GAL 18V-40, L-BOXX) A/Grinder	£348.86
06019H9001	Angle Grinder	GWS 18V-7 125mm (body only, carton) A/Grinder	£126.98
06019H9002	Angle Grinder	GWS 18V-7 125mm (body only, L-BOXX) A/Grinder	£152.42
06019H9103	Angle Grinder X-LOCK	GWX 18V-7 115mm (body only, carton) X-LOCK BRUSHLESS 18V A/Grinder	£143.26
06019H9104	Angle Grinder X-LOCK	GWX 18V-7 115mm (body only, L-BOXX) X-LOCK BRUSHLESS 18V A/Grinder	£163.61
06019J4000	Angle Grinder	GWS 18V-10 115mm (body only, carton) BRUSHLESS 18V A/Grinder	£165.57
06019J4001	Angle Grinder	GWS 18V-10 115mm (body only, L-BOXX) BRUSHLESS 18V A/Grinder	£167.90
06019J4002	Angle Grinder	GWS 18V-10 125mm (body only, carton) BRUSHLESS 18V A/Grinder	£152.22
06019J4003	Angle Grinder	GWS 18V-10 125mm (body only, L-BOXX) BRUSHLESS 18V A/Grinder	£167.90
06019G340B	Angle Grinder	GWS 18V-10 SC 125mm (body only, L-BOXX) BRUSHLESS 18V A/Grinder	£273.70
06019J4100	Angle Grinder	GWS 18V-10 P (body only, carton)	£165.44
06019J4102	Angle Grinder	GWS 18V-10 P (body only, L-BOXX)	£183.04
06019G3F0B	Angle Grinder	GWS 18V-10 PSC 125mm (body only, L-BOXX) BRUSHLESS 18V A/Grinder	£242.57
06017B0100	Angle Grinder X-LOCK	GWX 18V-10 125mm (body only, carton) X-LOCK BRUSHLESS 18V A/Grinder	£172.57
06017B0101	Angle Grinder X-LOCK	GWX 18V-10 125mm (body only, L-BOXX) X-LOCK BRUSHLESS 18V A/Grinder	£192.92
06019J4200	Angle Grinder X-LOCK	GWX 18V-10 P (body only, carton) X-LOCK BRUSHLESS 18V A/Grinder	£184.80
06019J4201	Angle Grinder X-LOCK	GWX 18V-10 P (body only, L-BOXX) X-LOCK BRUSHLESS 18V A/Grinder	£202.40
06019H6000	Angle Grinder	GWS 18V-15 C 125mm (body only, L-BOXX) BITURBO BRUSHLESS 18V A/Grinder	£277.57
06019H6100	Angle Grinder	GWS 18V-15 SC 125mm (body only, L-BOXX) + GCY 42 (CoMo) BITURBO BRUSHLESS 18V A/Grinder	£303.62
06019H6A00	Angle Grinder	GWS 18V-15 P 125mm (body only, carton) BITURBO BRUSHLESS 18V A/Grinder	£258.19
06019H6500	Angle Grinder X-LOCK	GWX 18V-15 SC 125mm (body only, L-BOXX) + GCY 42 (CoMo) BITURBO BRUSHLESS X-LOCK 18V A/Grinder	£323.97
06019H6F00	Angle Grinder X-LOCK	GWX 18V-15 P 125mm (body only, carton) BITURBO BRUSHLESS X-LOCK 18V A/Grinder	£277.99
06019H6G00	Angle Grinder X-LOCK	GWX 18V-15 PSC 125mm (body only, carton) + GCY 42 (CoMo) BITURBO BRUSHLESS X-LOCK 18V A/Grinder	£313.39
06019H6L01	Angle Grinder	GWS 18V-180 P (body only, 1x diamond disc, 2x bonded discs, carton) BITURBO BRUSHLESS 18V A/Grinder	£288.29
06012B4001	Straight Grinder	GGG 18V-10 SLC (body only, carton) BRUSHLESS 18V S/Grinder	£310.13
06012B4000	Straight Grinder	GGG 18V-10 SLC (body only, L-BOXX) BRUSHLESS 18V S/Grinder	£330.48
06019B5401	Straight Grinder	GGG 18V-20 (body only, carton) BRUSHLESS 18V S/Grinder	£178.27
06019B5400	Straight Grinder	GGG 18V-20 (body only, L-BOXX) BRUSHLESS 18V S/Grinder	£198.62
0601229100	Straight Grinder	GGG 18V-23 L C (body only, L-BOXX) BRUSHLESS 18V S/Grinder	£231.99
0601229200	Straight Grinder	GGG 18V-23 PLC (body only, L-BOXX) BRUSHLESS 18V S/Grinder	£240.13
06013A7000	Spot Grinder	GWS 12V-50 S (body only, carton)	£183.92
0601926105	Shear	GSC 12V-13 (body only, carton) 12V Shear	£280.29

PART NUMBER	PRODUCT TYPE	DESCRIPTION	BOSCH LIST PRICE (EX. VAT)
06019B2901	Shear	GLS 12V-300 (body only, carton) 12V Shear	£115.63
0601926300	Shear	GSC 18V-16 E (body only, carton) 18V Shear	£408.67
0601529600	Nibbler	GNA 18V-16 E (body only, carton) 18V Nibbler	£448.27
06019E3000	Dust Extractor	GAS 12V (crevice nozzle, L-BOXX inlay, carton) 12V Dust Extractor	£77.62
06019C6200	Dust Extractor	GAS 18V-1 (body only, carton) 18V Dust Extraction	£86.48
06019C6302	Dust Extractor	GAS 18V-10L Premium (body only, carton) 18V Dust Extraction	£151.17
06019K2000	Dust Extractor	GAS 18V-12 MC (body only, GCT 30-42, carton) BITURBO BRUSHLESS Dust Extraction	£458.96
1600A02GF2	Auto-Start Kit	GCA 30-42 + GCT 30-42 (110V) A/Start	£143.79
1600A02GF3	Auto-Start Kit	GCA 30-42 + GCT 30-42 (230V) A/Start	£143.79
1600A02GG1	Auto-Start Tag	GCT 30-42 A/Start	£43.47
06019F5100	Blower	GBL 18V-120 (body only, 4x accessories, carton) 18V Blower	£71.28
06019C4100	Caulk Gun	GCG 18V-310 (body only, carton) 18V C/Gun	£293.85
06019C4001	Caulk Gun	GCG 18V-600 (body only, carton) 18V C/Gun	£304.13
06012A6500	Heat Gun	GHG 18V-50 (body only, carton) 18V H/Gun	£170.49
06012A6501	Heat Gun	GHG 18V-50 (body only, L-BOXX) 18V H/Gun	£191.24
0601481000	Nail Gun	GNH 18V-64 M (body only, carton) 18V N/Gun	£463.17
0601481001	Nail Gun	GNH 18V-64 M (body only, L-BOXX) 18V N/Gun	£478.63
0601481070	Nail Gun	GNH 18V-64 M (2x ProCORE18V 4.0Ah, GAL 18V-40, L-BOXX) 18V N/Gun	£651.82
0601482000	Nail Gun	GNH 18V-64-2 M (body only, carton) 18V N/Gun	£526.66
0601482001	Nail Gun	GNH 18V-64-2 M (body only, L-BOXX) 18V N/Gun	£554.33
0601482200	Nail Gun	GNH 18V-64 MD (body only, carton) 18V N/Gun	£533.98
0601482201	Nail Gun	GNH 18V-64 MD (body only, L-BOXX) 18V N/Gun	£560.85
0601482400	Nail Gun	GNH 18V-50 M (body only, carton) 18V N/Gun	£530.86
0601482401	Nail Gun	GNH 18V-50 M (body only, L-BOXX) 18V N/Gun	£559.28
0601482500	Nail Gun	GTH 18V-38 M (body only, carton) 18V N/Gun	£540.89
0601482501	Nail Gun	GTH 18V-38 M (body only, L-BOXX) 18V N/Gun	£569.32
06019L7000	Concrete Nail Gun	GNB 18V-38 (body only, carton) BITURBO BRUSHLESS Concrete N/Gun	£632.81
06019L7001	Concrete Nail Gun	GNB 18V-38 (body only, XL-BOXX) BITURBO BRUSHLESS Concrete N/Gun	£664.49
06019L7071	Concrete Nail Gun	GNB 18V-38 (2x ProCORE18V 4.0Ah, GAL 18V-40, XL-BOXX) BITURBO BRUSHLESS Concrete N/Gun	£845.86
1600A02F4K	Consumable	NB-16 (carton) 1,000x 16mm Concrete Nails	£103.75
1600A02F4L	Consumable	NB-19 (carton) 1,000x 19mm Concrete Nails	£105.34
1600A02F4M	Consumable	NB-25 (carton) 1,000x 25mm Concrete Nails	£106.92
1600A02F4N	Consumable	NB-32 (carton) 1,000x 32mm Concrete Nails	£107.71
1600A02F4P	Consumable	NB-38 (carton) 1,000x 38mm Concrete Nails	£110.88
1600A02F4R	Consumable	NK-35 (carton) 1,000x 35mm Knurled Concrete Nails	£109.30

PART NUMBER	PRODUCT TYPE	DESCRIPTION	BOSCH LIST PRICE (EX. VAT)
1600A02F4S	Consumable	NM-13 (carton) 1,000x 13mm Steel Nails	£102.96
1600A02F4T	Consumable	NM-16 (carton) 1,000x 16mm Steel Nails	£103.75
1600A02F4U	Consumable	NM-19 (carton) 1,000x 19mm Steel Nails	£105.34
06019K5000	Rivet Gun	GRG 18V-16 C (body only, carton) BRUSHLESS 18V R/Gun	£722.83
06019K5002	Rivet Gun	GRG 18V-16 C (body only, L-BOXX) BRUSHLESS 18V R/Gun	£788.76
06019K5071	Rivet Gun	GRG 18V-16 C (2x GBA 2.0Ah, GAL 18V-40, L-BOXX) BRUSHLESS 18V R/Gun	£835.16
06019K8000	Dry Wall Cut-out Tool	GCU 18V-30 (body only, carton) BRUSHLESS 18V Drywall Cut-Out Tool	£166.87
06014A1000	Light	GLI 12V-300 (body only, carton) 12V Light	£44.35
06014A0000	Light	GLI 12V-330 (body only, carton) 12V DecliLED 12V Light	£51.46
06014A1100	Light	GLI 18V-300 (body only, carton) 18V Light	£39.06
0601443600	Light	GLI 18V-800 (body only, carton) 18V Light	£81.09
0601446700	Light	GLI 18V-1200 C (body only, carton) 18V Light	£90.35
0601446400	Light	GLI 18V-1900 (body only, carton) 18V Light	£104.54
0601446501	Light	GLI 18V-2200 C (body only, carton) 18V Light	£134.64
0601446800	Light	GLI 18V-4000 C (body only, carton) 18V Light	£200.24
0601446900	Light	GLI 18V-10000 C (body only, carton) 18V Light	£301.19
06188000MT	Lighting Tripod	GLT 300-40 (carton) L/Tripod	£142.77
06014A3070	Radio	GPB 18V-2 C (230V) Bluetooth Radio (carton) 230V / 18V Radio	£131.87
06014A3170	Radio	GPB 18V-2 SC (230V) Bluetooth & DAB+ Radio (carton) 230V / 18V Radio	£166.85
06014A4170	Radio	GPB 18V-5 SC (230V) Bluetooth & DAB+ Radio (carton) 230V / 18V Radio	£286.21
1600Z0002X	Battery	GBA 2.0Ah (carton) 12V Battery	£45.35
1600A00X79	Battery	GBA 3.0Ah (carton) 12V Battery	£54.35
1600A00X7H	Battery	GBA 6.0Ah (carton) 12V Battery	£72.45
1600Z00036	Battery	GBA 2.0Ah (carton) COOLPACK 1.0 18V Battery	£54.01
1600Z00038	Battery	GBA 4.0Ah (carton) COOLPACK 1.0 18V Battery	£75.20
1600A002U5	Battery	GBA 5.0Ah (carton) COOLPACK 1.0 18V Battery	£83.64
1600A016GB	Battery	ProCORE18V 4.0Ah (carton) COOLPACK 2.0 18V Battery	£94.92
1600A02149	Battery	ProCORE18V 5.5Ah (carton) COOLPACK 2.0 18V Battery	£147.80
1600A016GK	Battery	ProCORE18V 8.0Ah (carton) COOLPACK 2.0 18V Battery	£170.45
1600A016GU	Battery	ProCORE18V 12.0Ah (carton) COOLPACK 2.0 18V Battery	£225.48
1600A02X00	Battery	ProCORE18V+ 8.0Ah (carton) Tabless High Endurance COOLPACK 2.0 18V Battery	£183.04
1600Z0003B	Battery	GBA 2.0Ah (carton) COOLPACK 1.0 36V Battery	£146.96
1600A00L1M	Battery	GBA 6.0Ah (carton) COOLPACK 1.0 36V Battery	£210.01
1600A016NH	Attachment	GCY 42 Connectivity Module (carton) 18V Attachment	£26.86
06188000L6	Charging Adapter	GAA 18V-48 (body only, carton)	£34.32
1600A019R4	Charger	GAL 12V-40 (carton) 12V Fast Charger	£39.89
1600A019RK	Charger	GAL 18V-40 (carton) 18V Compact Charger	£46.01

Promotions and pricing available from 01/05/2024 to 31/08/2024 or while stocks last. Bosch List Price is for illustrative purposes and dealers shall determine their own resale price.



PART NUMBER	PRODUCT TYPE	DESCRIPTION	BOSCH LIST PRICE (EX. VAT)
1600A008BH	Charger	GAL 1880 CV (carton) 18V Multi-Volt Fast Charger	£77.81
1600A0275H	Charger	GAL 18V-160 (carton) 18V Fast Charger	£105.85
1600A019S8	Charger	GAL 18V-160 C (carton) + GCY 42 (CoMo) 18V Fast Charger	£116.42
1600A004ZT	Charger	GAL 3680 CV (carton) 36V Multi-Volt Fast Charger	£97.42
1600A01U9M	Charger	GAL 18V-80 (carton) 18V Multi-Bay 6 Port Fast Charger	£117.57
1600A019R9	Starter Set	2x GBA 2.0Ah + GAL 12V-40 (carton) 12V Starter Set	£81.40
1600A019RE	Starter Set	2x GBA 3.0Ah + GAL 12V-40 (carton) 12V Starter Set	£113.07
1600A01ND0	Starter Set	1x GBA 2.0Ah + 1x GBA 4.0Ah + GAL 12V-40 (carton) 12V Starter Set	£100.12
1600A01B21	Starter Set	2x GBA 6.0Ah + GAL 12V-40 (carton) 12V Starter Set	£164.94
1600A019S1	Starter Set	2x GBA 4.0Ah CoolPack + GAL 18V-40 (carton) 18V Starter Set	£164.43
1600A008BK	Starter Set	2x GBA 5.0Ah CoolPack + GAL 1880 CV (carton) 18V Starter Set	£224.11
1600A01U7V	Starter Set	1x ProCORE 18V 4.0Ah + GAL 18V-40 (carton) 18V Starter Set	£113.96
1600A01BA4	Starter Set	2x ProCORE 18V 4.0Ah + GAL 18V-40 (carton) 18V Starter Set	£194.95
1600A0214D	Starter Set	2x ProCORE 18V 5.5Ah + GAL 1880 CV (carton) 18V Starter Set	£267.70
1600A0275S	Starter Set	2x ProCORE 18V 8.0Ah + GAL 18V-160 (carton) 18V Starter Set	£335.37
1600A0275X	Starter Set	2x ProCORE 18V 12.0Ah + GAL 18V-160 (carton) 18V Starter Set	£483.52
06019A6979	Twin Pack	GSB 12V-15 + GDR 12V-105 (2x GBA 2.0Ah, GAL 12V-20, Tool Bag)	£188.61
06019H1175	Combi	GSB 18V-21 (2x GBA 2.0Ah, GAL 18V-40, L-BOXX) 18V Combi	£167.90
06015A6174	Jig Saw	GST 18V-L1B (2x GBA 4.0Ah, GAL 18V-40, L-BOXX) J/Saw	£342.14
06019G5172	Twin Pack	GSB 18V-21 + GDR 18V-160 (2x GBA 2.0Ah, GAL 1820 CV, L-BOXX) 18V Combi 2P	£254.48
06019J2171	Twin Pack	GSB 18V-55 + GDR 18V-200 (2x GBA 4.0Ah, GAL 18V-40, L-CASE) BRUSHLESS LIGHTseries 18V Combi 2P	£316.67
06019J2271	Twin Pack	GSB 18V-55 + GDX 18V-200 (2x GBA 4.0Ah, GAL 18V-40, L-CASE) BRUSHLESS LIGHTseries 18V Combi 2P	£327.75
0615990M2B	Combo 4 Pack	BAG+4 LS GSB 18V-55, GDR 18V-200, GBH 18V-21, GWS 18V-10 (3x GBA 4.0Ah, GAL 18V-40, LBAG+) 18V 4 Pack	£721.20
1600A012FZ	Mobility	L-BOXX 102 Mobility	£38.26
1600A012G0	Mobility	L-BOXX 136 Mobility	£43.96
1600A012G2	Mobility	L-BOXX 238 Mobility	£51.28
1600A012G3	Mobility	L-BOXX 374 Mobility	£62.68
1600A0259V	Mobility	XL-BOXX Mobility	£64.31
1600A001S0	Mobility	Foam Insert 102 Mobility	£20.59
1600A001S1	Mobility	Foam Insert 136 Mobility	£22.18
1600A025A1	Mobility	Foam Pad Set 5pcs Mobility	£5.70
1600A0259W	Mobility	Lid Insert XL-BOXX Mobility	£9.77
1600A0259X	Mobility	Partition Walls XL-BOXX Mobility	£31.75
1600A0259Y	Mobility	Foam Insert XL-BOXX Mobility	£37.22
1600A001S7	Mobility	i-BOXX 53 Set 12 Mobility	£33.26
1600A001S8	Mobility	i-BOXX 72 Set 10 Mobility	£34.19
1600A001R0	Mobility	LS-BOXX 306 Mobility	£61.05
1600A001SD	Mobility	LS-Tray 72 Mobility	£14.26
1600A001RX	Mobility	LS-Tray 92 Mobility	£14.26
1600A001SF	Mobility	i-BOXX Shelf 3pcs Mobility	£79.77
1600A001RV	Mobility	i-BOXX 53 Mobility	£15.47

PART NUMBER	PRODUCT TYPE	DESCRIPTION	BOSCH LIST PRICE (EX. VAT)
1600A001RW	Mobility	i-BOXX 72 Mobility	£15.47
1600A001S5	Mobility	i-BOXX Inset Box Set 12pcs Mobility	£20.35
1600A001S6	Mobility	i-BOXX Inset Box Set 10pcs Mobility	£25.34
1600A001SE	Mobility	i-BOXX Rack Lid Mobility	£29.30
1600A00222	Mobility	LT-BOXX 170 Mobility	£43.96
1600A00223	Mobility	LT-BOXX 272 Mobility	£54.54
1600A001S9	Mobility	L-BOXX Roller Mobility	£100.12
1600A001SA	Mobility	Alu-Caddy Collapsible Mobility	£136.75
1600A003BJ	Mobility	MBAG+ Bag (Medium)	£35.82
1600A003BK	Mobility	LBAG+ Bag (Large)	£35.82
1600A025A2	Mobility	L-BOXX Micro Mobility	£5.70
1600A0265U	Mobility	ProClick Holder (carton)	£4.88
1600A0265M	Mobility	Belt 93 (carton) Small/Medium Tool Belt	£30.12
1600A0265N	Mobility	Belt 108 (carton) Large/X-Large Tool Belt	£30.12
1600A0265S	Mobility	GWT 2 (carton) 2 Compartment Tool Belt Pouch	£29.30
1600A0265T	Mobility	GWT 4 (carton) 4 Compartment Tool Belt Pouch	£43.96
1600A0265P	Mobility	Tool Belt Kit 93 (1x Belt 93, 1x GWT 2, 1x GWT 4, 2x ProClick Holder, carton)	£90.35
1600A0265R	Mobility	Tool Belt Kit 108 (1x Belt 108, 1x GWT 2, 1x GWT 4, 2x ProClick Holder, carton)	£90.35
1600A025L6	Mobility	GWT 20 (L-BOXX compatible, carton) Totebag	£68.38
06188000DX	Heated Jacket	GHJ 12+18V XA S (Jacket, GAA 12V-21) 12/18V H/Jacket	£165.53
06188000DY	Heated Jacket	GHJ 12+18V XA M (Jacket, GAA 12V-21) 12/18V H/Jacket	£165.53
06188000DZ	Heated Jacket	GHJ 12+18V XA L (Jacket, GAA 12V-21) 12/18V H/Jacket	£165.53
06188000E0	Heated Jacket	GHJ 12+18V XA XL (Jacket, GAA 12V-21) 12/18V H/Jacket	£165.53
06188000E1	Heated Jacket	GHJ 12+18V XA 2XL (Jacket, GAA 12V-21) 12/18V H/Jacket	£165.53
06188000E2	Heated Jacket	GHJ 12+18V XA 3XL (Jacket, GAA 12V-21) 12/18V H/Jacket	£165.53
06188000EA	Heated Vest	GHV 12+18V XA S (Vest, GAA 12V-21) 12/18V H/Vest	£148.90
06188000EB	Heated Vest	GHV 12+18V XA M (Vest, GAA 12V-21) 12/18V H/Vest	£148.90
06188000EC	Heated Vest	GHV 12+18V XA L (Vest, GAA 12V-21) 12/18V H/Vest	£148.90
06188000ED	Heated Vest	GHV 12+18V XA XL (Vest, GAA 12V-21) 12/18V H/Vest	£148.90
06188000EE	Heated Vest	GHV 12+18V XA 2XL (Vest, GAA 12V-21) 12/18V H/Vest	£148.90
06188000EF	Heated Vest	GHV 12+18V XA 3XL (Vest, GAA 12V-21) 12/18V H/Vest	£148.90
06188000EP	Heated Hoodie	GHH 12+18V XA S (Hoodie, GAA 12V-21) 12/18V H/Hoodie	£140.18
06188000ER	Heated Hoodie	GHH 12+18V XA M (Hoodie, GAA 12V-21) 12/18V H/Hoodie	£140.18
06188000ES	Heated Hoodie	GHH 12+18V XA L (Hoodie, GAA 12V-21) 12/18V H/Hoodie	£140.18
06188000ET	Heated Hoodie	GHH 12+18V XA XL (Hoodie, GAA 12V-21) 12/18V H/Hoodie	£140.18
06188000EU	Heated Hoodie	GHH 12+18V XA 2XL (Hoodie, GAA 12V-21) 12/18V H/Hoodie	£140.18
06188000EV	Heated Hoodie	GHH 12+18V XA 3XL (Hoodie, GAA 12V-21) 12/18V H/Hoodie	£140.18
1600A016BH	Hand Tool	Professional Tape Measure 5m (metric, carton)	£17.91
1600A016BN	Hand Tool	Professional Spirit Level 25cm (magnetic, carton)	£28.56
1600A016BP	Hand Tool	Professional Spirit Level 60cm (non-magnetic, carton)	£43.14

PART NUMBER	PRODUCT TYPE	DESCRIPTION	BOSCH LIST PRICE (EX. VAT)
1600A016BR	Hand Tool	Professional Spirit Level 120cm (non-magnetic, carton)	£69.70
1600A01TH6	Hand Tool	Professional Snap-off Knife (carton)	£11.40
1600A016BL	Hand Tool	Professional Folding Knife (3x blades, carton)	£18.22
1600A016BM	Hand Tool	Professional Knife Set (1x Folding Knife, 1x Snap-off Knife, carton)	£23.61
1600A016ZH	Hand Tool	Professional Spare Blades (10x blades, carton)	£4.88
1600A016BF	Hand Tool	Professional Screwdriver Set (6pcs: SL 3.5, SL 4.5, SL 5.5, SL 6.5, PH1, PH2, carton)	£32.56
1600A02CV3	Hand Tool	Professional Screwdriver Set (6pcs: SL 3.5, SL 6.5, PH1, TX15, TX20, PZ2, carton)	£29.30
1600A016BG	Hand Tool	Professional Plier Set (1x 200mm Long Nose, 1x 180mm Combination, 1x 160mm Diagonal Cutter, carton)	£38.26
1600A01V03	Hand Tool	Professional Wire Stripper (0-10mm diameter, carton)	£16.28
1600A02Z3D	Hand Tool	Professional Ratchet/Spanner Set (5pcs: 8, 10, 13, 17, 19mm, canvas bag in carton)	£57.68
1600A02AU0	Hand Tool	Professional Ratchet/Spanner Set (10pcs: 8, 10, 12, 13, 14, 15, 16, 17, 18, 19mm, canvas bag in carton)	£98.21
1600A01TH4	Hand Tool	Professional Torx Allen Keys Set (9pcs: 10, 15, 20, 25, 27, 30, 40, 45, 50mm, carton)	£17.91
1600A01TH5	Hand Tool	Professional Hex Allen Keys Set (9pcs: 1.5, 2, 2.5, 3, 4, 5, 6, 8, 10mm, carton)	£17.91
1600A02W3N	Hand Tool	Waterpump 250mm Ironman Pliers (carton)	£29.26
1600A02W3R	Hand Tool	Wrench 250mm Ironman Plier (carton)	£49.32
1600A02W3T	Hand Tool	S-Shape Corner Pipe Wrench 45° 420mm (carton)	£45.98
1600A02W3V	Hand Tool	Corner Pipe Wrench 90° 420mm (carton)	£45.98
1600A02NC0	Hand Tool VDE	VDE Screwdriver SL 2.5 (carton)	£4.18
1600A02NC1	Hand Tool VDE	VDE Screwdriver SL 3.5 (carton)	£5.02
1600A02NC2	Hand Tool VDE	VDE Screwdriver SL 4.5 (carton)	£6.69
1600A02NC3	Hand Tool VDE	VDE Screwdriver SL 5.5 (carton)	£6.69
1600A02NC4	Hand Tool VDE	VDE Screwdriver SL 6.5 (carton)	£7.52
1600A02NB8	Hand Tool VDE	VDE Screwdriver PH 1 (carton)	£6.69
1600A02NB9	Hand Tool VDE	VDE Screwdriver PH 2 (carton)	£7.52
1600A02NC5	Hand Tool VDE	VDE Screwdriver TX 10 (carton)	£5.85
1600A02NC6	Hand Tool VDE	VDE Screwdriver TX 15 (carton)	£5.85
1600A02NC7	Hand Tool VDE	VDE Screwdriver TX 20 (carton)	£6.69
1600A02NC8	Hand Tool VDE	VDE Screwdriver TX 25 (carton)	£6.69
1600A02NC9	Hand Tool VDE	VDE Screwdriver TX 30 (carton)	£7.52
1600A02ND0	Hand Tool VDE	VDE Screwdriver TX 40 (carton)	£7.52
1600A02ND1	Hand Tool VDE	VDE Screwdriver PZ 1 (carton)	£6.69
1600A02ND2	Hand Tool VDE	VDE Screwdriver PZ 2 (carton)	£7.52
1600A02ND3	Hand Tool VDE	VDE Screwdriver PZ 3 (carton)	£7.94
1600A02ND4	Hand Tool VDE	VDE Screwdriver SL/PH 1 (carton)	£10.03
1600A02ND5	Hand Tool VDE	VDE Screwdriver SL/PH 2 (carton)	£11.70
1600A02ND6	Hand Tool VDE	VDE Screwdriver SL/PZ 1 (carton)	£10.03
1600A02ND7	Hand Tool VDE	VDE Screwdriver SL/PZ 2 (carton)	£11.70
1600A02ND8	Hand Tool VDE	Voltage Tester SL 3 (carton)	£5.85
1600A02NF3	Hand Tool VDE	VDE Socket Wrench Set (6pcs: 7, 8, 10, 12, 13, 14 mm, carton)	£82.76
1600A02NF7	Hand Tool VDE	VDE Screwdriver Set (7pcs: SL 2.5, SL 3.5, SL 5.5, SL 6.5, PH 1, PH 2, Voltage Tester, carton)	£34.28
1600A02NF8	Hand Tool VDE	VDE Screwdriver Set (7pcs: TX 10, 15, 20, 25, 30, 40, Voltage Tester, carton)	£33.44

PART NUMBER	PRODUCT TYPE	DESCRIPTION	BOSCH LIST PRICE (EX. VAT)
1600A02NF9	Hand Tool VDE	VDE Screwdriver Set (144pcs: SL 2.5, SL 3.5, SL 5.5, SL 6.5, PH 1, PH 2, PZ 1, PZ 2, SL/PZ 1, SL/PZ 2, TX 10, TX 15, TX 20, Voltage Tester, L-BOX)	£75.24
1600A02ND9	Hand Tool VDE	VDE Diagonal Side Cutter 160mm (carton)	£19.23
1600A02NE1	Hand Tool VDE	VDE Combination Plier 180mm (carton)	£19.23
1600A02NE2	Hand Tool VDE	VDE High Leverage Diagonal Side Cutter 200mm (carton)	£26.75
1600A02NE3	Hand Tool VDE	VDE Long Nose Plier Straight 200mm (carton)	£20.90
1600A02NE4	Hand Tool VDE	VDE Long Nose Plier bent 40° (carton)	£20.90
1600A02NE5	Hand Tool VDE	VDE Waterpump Plier 250mm (carton)	£32.60
1600A02NE6	Hand Tool VDE	VDE Crimping Plier 180mm (carton)	£26.75
1600A02NE7	Hand Tool VDE	VDE Universal Wirestripper 160mm (carton)	£20.90
1600A02NF4	Hand Tool VDE	VDE Cable Shear 200mm (carton)	£32.60
1600A02NG0	Hand Tool VDE	VDE Plier Set (3pcs: Diagonal Side Cutter 160mm, Combination Pliers 180mm, Long Nose Pliers Straight 200mm, carton)	£54.34
1600A02NG1	Hand Tool VDE	VDE Plier Set (4pcs: Diagonal Side Cutter 160mm, Combination Pliers 180mm, Long Nose Pliers Straight 200mm, Wire Stripper 160mm, carton)	£71.90
1600A02NE9	Hand Tool VDE	VDE Open-end single spanner 8mm (carton)	£14.21
1600A02NF0	Hand Tool VDE	VDE Open-end single spanner 10mm (carton)	£15.05
1600A02NF1	Hand Tool VDE	VDE Open-end single spanner 13mm (carton)	£15.88
1600A02NF2	Hand Tool VDE	VDE Open-end single spanner 17mm (carton)	£17.56
1600A02NE8	Hand Tool VDE	VDE Open-end Spanner Set (4pcs: 8, 10, 13, 17 mm, carton)	£54.34
1600A02NF5	Hand Tool VDE	VDE Cable Knife (carton)	£15.05
1600A02NF6	Hand Tool VDE	VDE Dismantling Knife (carton)	£15.88
1600A02NG2	Hand Tool VDE	VDE Mixed Set (5 pcs: SL 3.5, SL 6.5, PH 2, Diagonal Side Cutter 160mm, Long Nose Pliers Straight 200mm, carton)	£54.34
1600A02NG3	Hand Tool VDE	VDE Mixed Set (7 pcs: SL 3.5, SL 6.5, PH 2, Diagonal Side Cutter 160mm, Long Nose Pliers Straight 200mm, Voltage tester, Dismantling Knife, carton)	£72.73
06011B2060	Rotary Drill	GBM 13-2 RE (110V) R/Drill (carton)	£226.51
06011B2070	Rotary Drill	GBM 13-2 RE (230V) R/Drill (carton)	£226.51
06011A7060	Stirrer	GRW 12 E (110V) Stirrer + 1x paddle (carton)	£387.29
06011A7070	Stirrer	GRW 12 E (230V) Stirrer + 1x paddle (carton)	£387.29
0601217160	Impact Drill	GSB 13 RE (110V) Impact Drill (carry case)	£77.33
0601217170	Impact Drill	GSB 13 RE (230V) Impact Drill (carry case)	£88.61
060114E560	Impact Drill	GSB 16 RE (110V) Impact Drill (carry case)	£153.85
060114E570	Impact Drill	GSB 16 RE (230V) Impact Drill (carry case)	£153.85
060119C560	Impact Drill	GSB 21-2 RE (110V) Impact Drill (carry case)	£226.04
060119C570	Impact Drill	GSB 21-2 RE (230V) Impact Drill (carry case)	£226.04
060118B060	Impact Drill	GSB 162-2 RE (110V) Impact Drill (carry case)	£543.31
060118B070	Impact Drill	GSB 162-2 RE (230V) Impact Drill (carry case)	£543.31
1600A001FJ	Dust Extractor	GDE 16 CYL Dust Extraction (carton)	£76.03
06112A6061	SDS-Plus	GBH 2-21 (110V) SDS-Plus + 3pcs SDS+ drill bit set (carry case)	£128.61

Promotions and pricing available from 01/05/2024 to 31/08/2024 or while stocks last. Bosch List Price is for illustrative purposes and dealers shall determine their own resale price.

PART NUMBER	PRODUCT TYPE	DESCRIPTION	BOSCH LIST PRICE (EX. VAT)
06112A6071	SDS-Plus	GBH 2-21 (230V) SDS-Plus + 3pcs SDS+ drill bit set (carry case)	£131.70
06112A3060	SDS-Plus	GBH 2-26 (110V) SDS-Plus (carry case)	£148.31
06112A3070	SDS-Plus	GBH 2-26 (230V) SDS-Plus (carry case)	£148.31
06112A4060	SDS-Plus	GBH 2-26 F (110V) SDS-Plus (carry case)	£175.11
06112A4070	SDS-Plus	GBH 2-26 F (230V) SDS-Plus (carry case)	£175.11
0611267561	SDS-Plus	GBH 2-28 (110V) SDS-Plus (L-BOXX)	£238.39
0611267571	SDS-Plus	GBH 2-28 (230V) SDS-Plus (L-BOXX)	£238.39
0611267661	SDS-Plus	GBH 2-28 F (110V) SDS-Plus (L-BOXX)	£263.74
0611267671	SDS-Plus	GBH 2-28 F (230V) SDS-Plus (L-BOXX)	£255.82
1600A00F85	Attachment	Dust Collection Cover Attachment (carton)	£12.21
061124A060	SDS-Plus	GBH 3-28 DFR (110V) SDS-Plus (carry case)	£340.56
061124A070	SDS-Plus	GBH 3-28 DFR (230V) SDS-Plus (carry case)	£340.56
0611332161	SDS-Plus	GBH 4-32 DFR (110V) + 20 accessories SDS-Plus (carry case)	£495.04
0611332171	SDS-Plus	GBH 4-32 DFR (230V) + 20 accessories SDS-Plus (carry case)	£495.04
1600A0015Z	Dust Extractor	GDE 16 Plus Dust Extraction (carton)	£76.03
0611269060	SDS-Max	GBH 5-40 D (110V) SDS-Max (carry case)	£555.96
0611264060	SDS-Max	GBH 5-40 DCE (110V) SDS-Max (carry case)	£662.93
0611264070	SDS-Max	GBH 5-40 DCE (230V) SDS-Max (carry case)	£662.93
0611265160	SDS-Max	GBH 8-45 D (110V) SDS-Max (carry case)	£787.25
0611265060	SDS-Max	GBH 8-45 DV (110V) SDS-Max (carry case)	£883.91
0611266160	SDS-Max	GBH 12-52 D (110V) SDS-Max (carry case)	£951.57
0611266060	SDS-Max	GBH 12-52 DV (110V) SDS-Max (carry case)	£1,044.36
1600A001G7	Dust Extractor	GDE 68 Dust Extraction (carton)	£39.07
1600A001G8	Dust Extractor	GDE 162 Dust Extraction (carton)	£55.00
0611338770	Breaker	GSH 5 (230V) Breaker (carry case)	£392.35
0611321060	Breaker	GSH 5 CE (110V) Breaker (carry case)	£610.84
0611321070	Breaker	GSH 5 CE (230V) Breaker (carry case)	£610.84
0611322060	Breaker	GSH 7 VC (110V) Breaker (carry case)	£800.29
0611316741	Breaker	GSH 11 E (110V) Breaker (carry case)	£646.27
0611316742	Breaker	GSH 11 E (230V) Breaker (carry case)	£646.27
0611336060	Breaker	GSH 11 VC (110V) Breaker (carry case)	£949.88
1600A001G9	Dust Extractor	GDE Max Dust Extraction (carton)	£125.36
0611335060	Breaker	GSH 16-28 (110V) Breaker (carry case)	£1,555.98
061130A060	Breaker	GSH 27 VC (110V) Breaker (carry case)	£1,829.52
1600A02JY7	Floor Removal Cart	GHT 130 (carton) Floor Removal Cart	£1,249.82
1600A001GA	Dust Extractor	GDE Hex Dust Extraction (carton)	£114.84
0601388164	Angle Grinder	GWS 7-115 (110V) A/Grinder (carton)	£73.70
0601388174	Angle Grinder	GWS 7-115 (230V) A/Grinder (carton)	£73.70
0601396161	Angle Grinder	GWS 9-115 S (110V) A/Grinder (carton)	£96.48
0601396171	Angle Grinder	GWS 9-115 S (230V) A/Grinder (carton)	£96.48
06013965P2	Angle Grinder	GWS 9-115 P (110V) A/Grinder (carton)	£104.62
06013965P1	Angle Grinder	GWS 9-115 P (230V) A/Grinder (carton)	£104.62
06017B1060	Angle Grinder X-LOCK	GWX 9-115 S (110V) X-LOCK A/Grinder (carton)	£103.38
06017B1070	Angle Grinder X-LOCK	GWX 9-115 S (230V) X-LOCK A/Grinder (carton)	£103.38

PART NUMBER	PRODUCT TYPE	DESCRIPTION	BOSCH LIST PRICE (EX. VAT)
06013A6160	Angle Grinder	GWS 12-125 (110V) A/Grinder (body only, carton)	£104.72
06013A6170	Angle Grinder	GWS 12-125 (230V) A/Grinder (body only, carton)	£104.72
06017D0160	Angle Grinder	GWS 14-125 S (110V) A/Grinder (carton)	£163.15
06017D0170	Angle Grinder	GWS 14-125 S (230V) A/Grinder (carton)	£163.15
1600A003DH	Dust Extractor	GDE 125 EA-S Dust Extraction (carton)	£65.93
1600A003DJ	Dust Extractor	GDE 125 EA-T Dust Extraction (carton)	£65.93
1600A003DK	Dust Extractor	GDE 115/125 FC-T Dust Extraction (carton)	£78.14
06018F4160	Angle Grinder	GWS 2200 P (110V) A/Grinder (carton)	£169.03
06018F4170	Angle Grinder	GWS 2200 P (230V) A/Grinder (carton)	£169.03
06018C1171	Angle Grinder	GWS 20-230 P (230V) A/Grinder (carton)	£141.84
06018C1170	Angle Grinder	GWS 22-230 P (230V) A/Grinder (carton)	£139.19
1600A003DL	Dust Extractor	GDE 230 FC-S Dust Extraction (carton)	£178.27
1600A003DM	Dust Extractor	GDE 230 FC-T Dust Extraction (carton)	£178.27
0601389060	Polisher	GPO 14 CE (110V) Polisher (carton)	£201.17
0601389070	Polisher	GPO 14 CE (230V) Polisher (carton)	£201.17
0601B28060	Cut-off Saw	GCD 12 JL (110V) B/Top (carton)	£645.48
0601B28070	Cut-off Saw	GCD 12 JL (230V) B/Top (carton)	£658.15
060160A170	Router	GKF 600 (230V) ¼" Palm Router (carry case)	£130.07
06016A0070	Laminate Trimmer	GLF 55-6 (230V) L/Trimmer (carton)	£105.85
0601220060	Straight Grinder	GGs 28 C (110V) S/Grinder (carton)	£187.70
0601220070	Straight Grinder	GGs 28 C (230V) S/Grinder (carton)	£187.70
06012B5060	Straight Grinder	GGs 30 LS (110V) S/Grinder (carton)	£186.94
06012B5070	Straight Grinder	GGs 30 LS (230V) S/Grinder (carton)	£186.94
0601222160	Straight Grinder	GGs 8 CE (110V) S/Grinder (carton)	£308.51
0601222170	Straight Grinder	GGs 8 CE (230V) S/Grinder (carton)	£308.51
06012A2370	Orbital Sander	GSS 160 Multi (230V) O/Sander (carton)	£152.06
0601387571	Random Orbital Sander	GEX 125-1 AE (230V) RO/Sander (carton)	£129.89
0601372860	Random Orbital Sander	GEX 34-150 (110V) RO/Sander (carton)	£220.59
0601372870	Random Orbital Sander	GEX 34-150 (230V) RO/Sander (carton)	£220.59
060137B270	Random Orbital Sander	GEX 40-150 (230V) RO/Sander (L-BOXX)	£318.07
0601257070	Random Orbital Sander	GET 55-125 (230V) RO/Sander (carton)	£363.53
0601257170	Random Orbital Sander	GET 75-150 (230V) RO/Sander (carton)	£388.08
06017D4060	Drywall Sander	GTR 55-225 (110V) D/Sander + 600mm extension pole, M480 sanding net, pad set (carry case)	£300.37
06017D4070	Drywall Sander	GTR 55-225 (230V) D/Sander + 600mm extension pole, M480 sanding net, pad set (carry case)	£300.37
06015A4070	Planer	GHO 16-82 D (230V) Planer (carton)	£144.14
06015A4370	Planer	GHO 26-82 D (230V) Planer (carry case)	£190.08
0601237071	Multi Cutter	GOP 30-28 (230V) Starlock Plus / Starlock M/Cutter + 1 blade (carton)	£131.47
0601237070	Multi Cutter	GOP 30-28 (230V) Starlock Plus / Starlock M/Cutter + 20 accessories (L-BOXX)	£247.10
0601231071	Multi Cutter	GOP 40-30 (230V) Starlock Plus / Starlock M/Cutter + 15 accessories (L-BOXX)	£293.04
060158F070	Jig Saw	GST 90 BE (230V) J/Saw (carry case)	£140.82
0601512070	Jig Saw	GST 150 CE (230V) J/Saw (carry case)	£200.38
0601513060	Jig Saw	GST 150 BCE (110V) J/Saw (carry case)	£196.42

PART NUMBER	PRODUCT TYPE	DESCRIPTION	BOSCH LIST PRICE (EX. VAT)
0601513070	Jig Saw	GST 150 BCE (230V) J/Saw (carry case)	£196.42
0601518070	Jig Saw	GST 160 BCE (230V) J/Saw (L-BOX)	£271.88
1600A001F7	Attachment	KS 3000 + FSN SA Attachment (carton)	£63.49
1600A001FS	Guide Rail	FSN SA Guide Rail (carton)	£12.21
0601623070	Circular Saw	GKS 190 (230V) C/Saw (carry case)	£147.44
0601667070	Circular Saw	GKS 65 (230V) C/Saw (carton)	£217.80
0601675061	Plunge Saw	GKT 55 GCE (110V) P/Saw (L-BOX)	£486.32
0601675071	Plunge Saw	GKT 55 GCE (230V) P/Saw (L-BOX)	£525.10
1600Z00005	Guide Rail	FSN 800 Guide Rail (carton)	£50.47
1600Z00006	Guide Rail	FSN 1100 Guide Rail (carton)	£85.93
1600A021AV	Guide Rail	FSN 1400 Guide Rail (carton)	£94.28
1600Z0000F	Guide Rail	FSN 1600 Guide Rail (carton)	£106.51
1600Z00007	Guide Rail	FSN 2100 Guide Rail (carton)	£119.66
1600Z00008	Guide Rail	FSN 3100 Guide Rail (carton)	£191.29
0615990M8Z	Guide Rail	FSN 1400 Guide Rail Kit (2x FSN 1400, FSN VEL, FSN Carry Bag, carton)	£191.66
1600Z0003V	Guide Rail	FSN RA 32 800 Guide Rail (carton)	£58.61
1600Z0003W	Guide Rail	FSN RA 32 1600 Guide Rail (carton)	£94.42
1600Z00009	Guide Rail	FSN VEL Guide Rail (carton)	£55.35
1600Z0000A	Guide Rail	FSN WAN Guide Rail (carton)	£91.17
1600Z0000C	Guide Rail	FSN KK Guide Rail (carton)	£13.46
1600A001F8	Guide Rail	FSN KZW Guide Rail (carton)	£55.35
1600Z0000D	Guide Rail	FSN SS Guide Rail (carton)	£22.18
1600Z0000E	Guide Rail	FSN HB Guide Rail (carton)	£22.18
1600Z0000M	Guide Rail	FSN RS Guide Rail (carton)	£22.18
1610Z00020	Mobility	FSN Carry Bag	£36.63
1600Z0000X	Guide Rail	Parallel Guide for GKT 55 GCE Guide Rail (carton)	£48.03
1600A001T8	Guide Rail	FSN OFA 32 KIT 800 Guide Rail (carton)	£176.62
16001640870	Reciprocating Saw	GSA 1100 E (230V) R/Saw (carry case)	£152.06
1600Z0003X	Attachment	RA 32 Attachment (carton)	£16.28
1600A001GJ	Attachment	TE 1600 Attachment (carton)	£91.17
060160A800	Attachment	TE 600 Attachment (carton)	£77.33
1600A0011C	Attachment	OFZ Attachment (carton)	£18.72
0601B19060	Mitre Saw	GCM 800 SJ (110V) M/Saw (carton)	£280.83
0601B19070	Mitre Saw	GCM 800 SJ (230V) M/Saw (carton)	£280.83
0601B19160	Mitre Saw	GCM 8 SJL (110V) M/Saw (carton)	£416.06
0601B19170	Mitre Saw	GCM 8 SJL (230V) M/Saw (carton)	£416.06
0601B19270	Mitre Saw	GCM 8 SDE (230V) M/Saw (carton)	£513.59
0601B49070	Mitre Saw	GCM 305-216 D (230V) M/Saw (carton)	£395.21
0601B49170	Mitre Saw	GCM 305-254 D (230V) M/Saw (carton)	£553.61
0601B23160	Mitre Saw	GCM 12 SDE (110V) M/Saw (carton)	£783.27
0601B23170	Mitre Saw	GCM 12 SDE (230V) M/Saw (carton)	£783.27
0601B23670	Mitre Saw	GCM 12 GDL (230V) M/Saw (carton)	£1,082.34
0601B15071	Mitre / Table Saw	GTM 12 JL (230V) M/T/Saw (carton)	£584.75
0601B30560	Table Saw	GTS 10 J (110V) T/Saw (carton)	£533.05
0601B30570	Table Saw	GTS 10 J (230V) T/Saw (carton)	£533.05
0601B30460	Table Saw	GTS 10 XC (110V) T/Saw (carton)	£786.75
0601B30470	Table Saw	GTS 10 XC (230V) T/Saw (carton)	£786.75
0601B42070	Table Saw	GTS 635-216 (230V) T/Saw (carton)	£434.02
0601B42071	Table Saw	GTS 635-216 (230V) T/Saw + GTA 560 Stand (carton)	£491.83
0601B22700	Stand	GTA 560 Stand (carton)	£77.33
0601B22001	Stand	GTA 600 Stand (carton)	£100.58
0601B12300	Stand	GTA 2600 Stand (carton)	£127.51
0601B24000	Stand	GTA 3800 Stand (carton)	£242.57
0601B24100	Stand	GTA 6000 Stand (carton)	£122.91

PART NUMBER	PRODUCT TYPE	DESCRIPTION	BOSCH LIST PRICE (EX. VAT)
0601B12000	Stand	GTA 60 W Stand (carton)	£227.92
0601B12100	Stand	GTA 2500 W Stand (carton)	£346.90
06012A6360	Heat Gun	GHG 23-66 (110V) Heat Gun (carry case)	£159.75
06012A6370	Heat Gun	GHG 23-66 (230V) Heat Gun (carry case)	£159.75
060197B170	Dust Extractor	GAS 20 L SFC (230V) Dust Extraction (carton)	£242.57
0601979141	Dust Extractor	GAS 25 L SFC (110V) Dust Extraction (carton)	£376.96
0601979142	Dust Extractor	GAS 25 L SFC (230V) Dust Extraction (carton)	£372.24
06019C3060	Dust Extractor	GAS 35 L SFC + (230V) Dust Extraction (carton)	£500.54
06019C3170	Dust Extractor	GAS 35 M AFC (110V) Dust Extraction (carton)	£685.08
06019C3160	Dust Extractor	GAS 35 M AFC (230V) Dust Extraction (carton)	£685.08
06019C3360	Dust Extractor	GAS 55 M AFC (230V) Dust Extraction (carton)	£833.98
06019C3660	Dust Extractor	GAS 35 H AFC (110V) Dust Extraction (carton)	£842.49
06019C3670	Dust Extractor	GAS 35 H AFC (230V) Dust Extraction (carton)	£877.88
0601575142	Rubber Cutter	GSG 300 (230V) Rubber Cutter (carton)	£586.87
06008D2000	Blower	GBL 18V-750 (body only, nozzle attachment, carton) BITURBO BRUSHLESS 18V Leaf Blower	£180.40
06008C8000	Lawn Mower	GRA 18V2-46 (body only, carton) 18V2 BITURBO BRUSHLESS L/Mower	£412.29
06008C9000	Hedge Trimmer	GHE 18V-60 (body only, carton) BRUSHLESS 18V H/Trimmer	£189.20
06008D1000	Brushcutter	GFR 18V-23 (body only, pro tab, shoulder strap, aux handle, barrier bar, plant protector, blade set, carton) BRUSHLESS 18V Brushcutter	£268.40
06008D0000	Grass Trimmer	GRT 18V-33 (body only, pro tab, shoulder strap, aux handle, barrier bar, plant protector, carton) BRUSHLESS 18V G/Trimmer	£242.00
F016800628	Cutting Line	AC (GFR, GRT): Cutting line (24m, 2.4mm)	£18.48
F016800629	Brushcutter Blade	AC (GFR, GRT): Brushcutter blade (steel, laser cut, 3-teeth, 23cm, 25.4mm)	£29.04
F016800631	Brushcutter Blade	AC (GFR, GRT): Brushcutter blade (steel, laser cut, 3-teeth, 23cm, 2mm, 25.4mm, spacer, locking blade, nut, assembly tools)	£33.44
F016800638	Mower Blade	AC (GRA): Mower blade (46cm)	£24.50
0601072900	Laser Measure	GLM 40 Professional Laser Measure	£94.76
0601072500	Laser Measure	GLM 50-22 Professional Laser Measure	£134.86
0601072V00	Laser Measure	GLM 50-25 G Professional Laser Measure	£176.97
0601072T00	Laser Measure	GLM 50-27 C Professional Laser Measure	£187.48
0601072U00	Laser Measure	GLM 50-27 CG Professional Laser Measure	£212.40
0601072U01	Laser Measure	GLM 50-27 CG + Li-Ion adapter Professional Laser Measure	£229.38
0601072Y00	Laser Measure	GLM 100-25 C Professional Laser Measure	£251.28
0601072Z00	Laser Measure	GLM 150-27 C Professional Laser Measure	£316.16
0601074000	Laser Measure	GWM 32 Professional Measuring Wheel	£79.13
0601074100	Measuring Wheel	GWM 40 Professional Measuring Wheel	£160.24
0601081000	Detector	GMS 120 Professional Detector	£109.82
0601081303	Detector	D-Tect 120 Professional Detector	£260.53
0601081370	Detector	D-Tect 120 Professional Detector (L-BOX)	£336.59

PART NUMBER	PRODUCT TYPE	DESCRIPTION	BOSCH LIST PRICE (EX. VAT)
0601081308	Detector	D-Tect 120 Professional Detector (body only, L-BOXX)	£295.04
0601081600	Detector	D-tect 200 C Professional Detector	£685.85
0601081608	Detector	D-tect 200 C Professional Detector (body only, L-BOXX)	£708.69
0601241500	Inspection Camera	GIC 12V-4-23 C Professional Inspection Camera	£224.98
0601241400	Inspection Camera	GIC 12V-5-27 C Professional Inspection Camera	£308.61
0601241402	Inspection Camera	GIC 12V-5-27 C Professional Inspection Camera (body only, L-BOXX)	£329.52
0601083370	Infrared Scanner	GIS 1000 C Professional Infrared Scanner	£353.90
0601083171	Thermal Imaging Camera	GTC 400 C Professional Thermal Imaging Camera (L-BOXX)	£1,071.67
0601083108	Thermal Imaging Camera	GTC 400 C Professional Thermal Imaging Camera (body only, L-BOXX)	£1,014.71
0601083570	Thermal Imaging Camera	GTC 600 C Professional Thermal Imaging Camera (L-BOXX)	£1,583.12
0601083508	Thermal Imaging Camera	GTC 600 C Professional Thermal Imaging Camera (body only, L-BOXX)	£1,530.32
0601066E00	Combi Laser	GCL 2-15 + RM1 Professional Combi Laser	£146.63
0601066E02	Combi Laser	GCL 2-15 + RM1 Professional Combi Laser (carry case)	£197.44
0601063W00	Line Laser	GLL 2-15 G + LB 10 Professional Line Laser	£168.06
0601063W01	Line Laser	GLL 2-15 G + LB 10 + BT 15 Tripod Professional Line Laser	£211.35
0601063W02	Line Laser	GLL 2-15 G + LB 10 + Ceiling clip Professional Line Laser (carry case)	£231.77
0601066J00	Combi Laser	GCL 2-15 G + RM1 Professional Combi Laser (carry case)	£245.52
0601066F01	Combi Laser	GCL 2-50 + LR6 Professional Combi Laser (carry case)	£223.28
0601066G00	Combi Laser	GCL 2-50 C + RM 2 Professional Combi Laser	£245.29
0601066M00	Combi Laser	GCL 2-50 G + RM 10 Professional Combi Laser	£250.27
0601066M01	Combi Laser	GCL 2-50 G + RM 10 + BT 150 Tripod Professional Combi Laser	£286.65
0601066M02	Combi Laser	GCL 2-50 G + RM 10 + Ceiling clip Professional Combi Laser (carry case)	£311.92
0601066H70	Combi Laser	GCL 2-50 CG + RM 2 Professional Combi Laser (L-BOXX)	£472.26
0601063S00	Plane Laser	GLL 3-80 Professional 360° Laser (carry case)	£370.81
0601063R00	Plane Laser	GLL 3-80 C Professional 360° Laser	£442.20
0601063R03	Plane Laser	GLL 3-80 C + BM 1 Professional Line Laser (body only, L-BOXX)	£502.31
0601063Y00	Plane Laser	GLL 3-80 G Professional Line Laser (carry case)	£527.40
0601063T70	Plane Laser	GLL 3-80 CG + BM 1 Professional Line Laser (L-BOXX)	£682.58
0601063T03	Plane Laser	GLL 3-80 CG + BM 1 Professional Line Laser (body only, L-BOXX)	£645.61
0601066N00	Point Laser	GPL 3 G Professional Point Laser	£197.89
0601066P00	Point Laser	GPL 5 G Professional Point Laser	£237.89
0601015200	Tile Laser	GTL 3 Professional Tile Laser	£180.42
0601061800	Rotation Laser	GRL 400 H + LR1 Professional Rotary Laser	£655.99
06159940JY	Rotation Laser	GRL 400 H + LR1 Professional Rotary Laser Set	£745.56
0601061F70	Rotation Laser	GRL 600 CHV + LR60 + RB60 + WM6 + RC6 Professional Rotary Laser	£1,888.96
0601061F01	Rotation Laser	GRL 600 CHV + LR60 + RB60 + BA1 Professional Rotary Laser (L-BOXX)	£1,757.36
0601061V70	Rotation Laser	GRL 650 CHVG + LR65G + RB60 + WM6 + RC6 Professional Rotary Laser	£2,169.35
0601061V01	Rotation Laser	GRL 650 CHVG + LR65G + RB60 + BA1 Professional Rotary Laser (L-BOXX)	£1,951.84

PART NUMBER	PRODUCT TYPE	DESCRIPTION	BOSCH LIST PRICE (EX. VAT)
0601068400	Optical Level	GOL 20 D Professional Optical Level	£180.18
0601068402	Optical Level	GOL 20 D Professional Optical Level Set	£261.02
0601068000	Optical Level	GOL 26 D Professional Optical Level	£207.90
0601068002	Optical Level	GOL 26 D Professional Optical Level Set	£276.67
0601068502	Optical Level	GOL 32 D Professional Optical Level Set	£317.57
0601076500	Angle Measurer	GAM 220 Professional Angle Measurer	£168.89
0601076600	Angle Measurer	GAM 220 MF Professional Angle Measurer	£186.07
0601076400	Angle Measurer	GAM 270 MFL Professional Angle Measurer	£281.45
0601076700	Incline Measurer	GIM 60 Professional Incline Measurer	£137.27
0601076900	Incline Measurer	GIM 60 L Professional Incline Measurer	£212.99
0601076800	Incline Measurer	GIM 120 Professional Incline Measurer	£184.59
0601015400	MT Accessories	LR 1 Professional Laser Receiver	£160.45
0601069100	MT Accessories	LR 2 Professional Laser Receiver	£131.77
0601069H00	MT Accessories	LR 6 Professional Laser Receiver	£67.71
0601069J00	MT Accessories	LR 7 Professional Laser Receiver	£105.12
0601069L00	MT Accessories	LR 45 Professional Laser Receiver	£235.28
0601069P00	MT Accessories	LR 60 Professional Laser Receiver	£325.77
0601069T00	MT Accessories	LR 65 G Professional Laser Receiver	£344.98
1608M00C1L	MT Accessories	Bracket for LR 6 and LR7	£26.80
0601015A01	MT Accessories	BM1 Professional Mount + Ceiling Clamp	£59.14
0601092C00	MT Accessories	LB 10 Professional Rotating Mount + Ceiling clamp	£36.04
0601092400	MT Accessories	WM 4 Professional Wall Mount	£95.85
1608M0070F	MT Accessories	Professional Receiver Bracket	£30.56
0601092700	MT Accessories	RM2 Professional Rotating Mount	£36.04
0601092800	MT Accessories	RM3 Professional Motorised Rotating Mount	£151.54
0601092A00	MT Accessories	RM 10 Professional Rotating Mount	£36.04
1608M0005C	MT Accessories	Red Laser Target	£14.78
0601069C00	MT Accessories	RC 2 Professional Remote	£53.97
1608M0005B	MT Accessories	Professional Red laser glasses	£16.00
1608M0005J	MT Accessories	Professional Green laser glasses	£18.48
1608M00C43	MT Accessories	Professional Li-Ion adapter	£36.96
1608M00C1B	MT Accessories	AA1 Professional Battery Adapter for 10.8/12V	£13.86
1600A02R6M	MT Accessories	8.3mm (1.5m) Camera Cable GIC 12V-4/5	£77.43
1600A02R6P	MT Accessories	8.3mm (3.5m) Camera Cable GIC 12V-4/5	£86.13
0601096B00	MT Accessories	BT 150 Professional Tripod	£54.09
0601096A00	MT Accessories	BT 250 Professional Tripod	£100.49
0601091200	MT Accessories	BT 160 Professional Tripod	£55.57
0601091B00	MT Accessories	BT 170 HD Professional Tripod	£81.96
0601091A00	MT Accessories	BT 300 HD Professional Tripod	£188.38
0601015B00	MT Accessories	BT 350 Professional Telescopic Pole	£146.97
0601094100	MT Accessories	GR 240 Professional Levelling Staff	£55.57
0601094300	MT Accessories	GR 500 Professional Levelling Staff	£44.45

## Repair Service

### Guarantee Repairs

All guarantee repairs remain free of charge subject to meeting the qualifying criteria. Simply complete the online enquiry form to start the process or take advantage of the Repair Online dealer hub within the Bosch B2B portal.

### Chargeable repairs via MaxPrice

- ▶ **A single upfront MaxPrice** for your repair
- ▶ Save time and money with unnecessary quotations and collections
- ▶ The cost of repair **will never exceed the MaxPrice**
- ▶ What if the repair cost is less than the MaxPrice? You will pay the lower price
- ▶ Example: GBH 36V-EC. MaxPrice - £100.00. Final repair cost £74.15. **You will pay £74.15**
- ▶ **Fast repair service:** we aim to return your repaired product within 5 working days
- ▶ Complete testing for performance and safety

Every MaxPrice repair includes a 6-month guarantee\*

\*On parts fitted

### Measuring Tool Calibration

It is important that your measuring tools function reliably and meet legal requirements. Calibration includes inspection of the laser quality, checking measurement and mathematical functions.

Go to [www.bosch-professional.co.uk](http://www.bosch-professional.co.uk) and click on **"Services"** for more details.



## Additional Online Services



### Guarantee registration

You can register online to extend the guarantee on your professional Power Tool from 1 to 3 years.

Visit [boschprofessional.com/pro360](http://boschprofessional.com/pro360) for details.



### Online Spare Parts Service

Illustrated spare part lists along with a reliable spare parts service for Professional Power Tools - the spare part you need is just a click away.

### User Manuals

Download and print out instruction manuals for current and discontinued tools free of charge on the service section of the website.

### Contact Us

#### Prioritised phone line

Allows you to get through to one of our advisors as quickly as possible on **0344 736 0109**.

#### Opening Hours

Our phone lines are now open between 8.00 and 17.00 5 days a week.

#### Email service

Our target is to respond to all emails within 48 hours. Any email queries should be sent to [boschservicecentre@uk.bosch.com](mailto:boschservicecentre@uk.bosch.com)



# BOSCH



## Chargeable Repairs via MaxPrice

**A single upfront MaxPrice for your chargeable repair, which will never be exceeded!**

If the final repair cost is less, you will pay the lower price.

Ask your Bosch dealer for more information or visit our website.

**Professional Service from Bosch Professional.**

[www.bosch-professional.com](http://www.bosch-professional.com)



**Bosch Professional**



# BOSCH



# ONLY TO GUARANTEE

Get the extended guarantee for your Bosch

**1** Create your PRO360 account once.

**2** Register your tools in seconds



**Bosch Professional**

<sup>1</sup> Excluded are high-frequency tools,  
More information on the 3 years gua





# 3 STEPS TO 3 YEARS WARRANTY ANTEE

Professional tools, batteries and chargers<sup>1</sup>.

1. Register your assets  
(via scan).

3. Enter the purchase date  
(max. 4 weeks) and  
upload your invoice.

PRC)))360



<sup>1</sup>Industrial cordless screwdrivers, pneumatic tools and supplied accessories.  
Warranty conditions can be found at: [www.bosch-professional.com/gb/en/service/guarantee/information/](http://www.bosch-professional.com/gb/en/service/guarantee/information/)

# MANY BRANDS. MANY TOOLS. ONE BATTERY SYSTEM.

Power for pros: AMPShare is the shared battery system that lets you run many tools from many pro brands with just one battery – powered by leading battery technology from Bosch Professional.



Powered by



More Information  
[ampshare.com](http://ampshare.com)



# ICONS EXPLAINED

Where icons are not self explanatory, please refer to our guide below.



# BOSCH



## Professional 18V System

Compatible since 2008: all Bosch batteries are compatible with new and existing Bosch Professional tools in the same voltage class.



## Tightening torque 320 Nm



## Tightening Torque 1600 Nm



## Tightening torque 2200 Nm



## Breakaway Torque 2200 Nm



## Breakaway torque 540 Nm



## 1/4" External Square Tool Holder



## 3/8" External Square Tool Holder



## 3/4" External Square Tool Holder



## Saw band dimensions 1140 x 12.4 x 0.5 mm



## Cutting depth 127 mm



## Rafter Hook



## Brushless Motor

The Brushless motor allows for a longer motor life, more runtime and more power.



## Toolless

No additional tools are required for configuring the tool, allowing for user-friendly operation.



## Overload Protection

In case of an overload situation, the tool will shut off automatically.



## Dust Extraction

Extracts directly into the integral dust bag on the tool and/or using an all-purpose dust extractor.



## Rebate Depth 0-9 mm



## Improved and flexible dust management

More dust and chips ejected than before and dual chip ejection.



## Stepless Depth Adjustment

Precision depth control that enables the user to set up individual nail lengths.



## Low Recoil

Gentle on the user's wrist thanks to very low recoil.



## One Handed Activation

Thumb-actuated power switch for efficient single-handed use.



## Nail Length 32-64 mm

Describes the nail length, diameter & wire gauge of the nails to be used in the nail gun.



## Inclination angle 20°

Describes the collation angle of the nails to be used in the nail gun.



## Dry Fire Lock-Out

Shows the user that the nailgun prevents blank firing when the nail magazine is empty, thus avoiding damage to tool & work piece.



## Firing Mode

The user can choose between single activation mode and contact ("bumpfire") activation mode.



## Staple Size

Describes the length & crown width of the staples to be used in the stapler.



## Easy Bit Insertion

Quick and easy insertion of the bits without pulling the sleeve.



## Connected Ready



## Disc Diameter 125 mm



## Capacity 46 mm

Max. Capacity for Pipes with water pump plier is 46 mm.



## Auto-Lock

Auto-lock ensures that everything remains firmly secured.



## Ergonomic

Ergonomic handling thanks to low weight and compact design.



## Soft Grip

Comfortable handling of the tool.



## Adjustable Modes

Allows for higher work efficiency.



## Speed Selection

Best work results with speed pre-selection for applications requiring material-specific speed.



## Constant Speed

Best work results thanks to electronic regulation of speed – even under load.



## Soft Start

The load and torque of the motor are temporarily reduced during start-up.



## Variable Speed Trigger

Allows for easy and precise control of the RPM.



## Restart Protection

Prevents autonomous restart of the tool after power blackout. Only through new, conscious activation will the tool be ready to use.



## Reduced Grip Size

Outstanding small grip size for best in class ergonomics.



## Belt Clip/ Belt Hook

Convenient hanging of the tool.



## LED Light

Illuminates the work area.



## Software GTC Transfer



## ThermalOn App



## Bosch Thermal App

# ALL INFORMATION IN ONE HAND.

## MeasureOn. Upgrade your efficiency.

With one app plus laser range finder, you have every project in your hand and under control. Sketch floor plans with your finger, add photos and notes, insert measurements and benefit from many more features – all in one app. And thanks to cloud-based project access, anywhere on all devices!

[www.bosch-professional.com/measureon](http://www.bosch-professional.com/measureon)



MeasureOn



TM of Google LLC



TM of Apple Inc.



**MeasureOn:  
Download now  
for free.**



# BOSCH



GLM 50-27 CG  
Professional



GLM 50-27 C  
Professional



GLM 120 C  
Professional



GLM 50 C  
Professional